

APPROVED  
 F. H. DAVIS  
 S. D. OUTSIDE

BOOK 647 PAGE 196

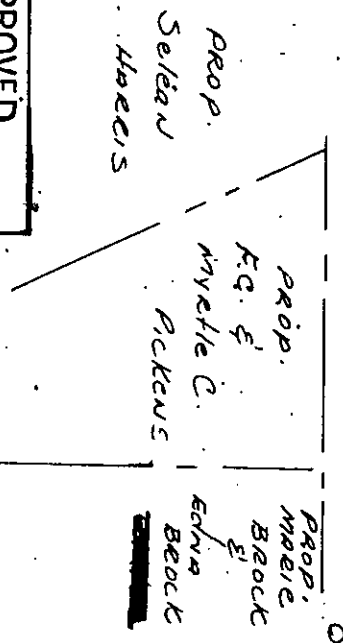

Name and Post Office Address F.C. Pickens  
 of Grantor Myrtle C. Pickens  
 #12 ~~Rebecca St.~~  
 Greenville, S.C.  
 Toll Line \_\_\_\_\_  
 Or Exchange Line Greenville  
 tributary to \_\_\_\_\_  
 The Property is bounded where the line enters and leaves this property by the property of:  
 Edna Brock ~~Edna Brock~~ on the E and  
 Selman Harris on the W  
 The poles (or stakes) have the following identification:  
 Authority P-51811 Classification P-1-C  
 Area Greenville, S.C.  
 Approved F. H. Davis  
 Title Supr Eng.

5297A 14245B

GEP 47.101 GENERAL PERMIT (INDIVIDUAL) Form 8416 Nov. '54

Received of the SOUTHERN BELL TELEPHONE AND TELEGRAPH COMPANY ONE AND --- No/100 Dollars in consideration of which (We) hereby grant said Company, its associated and allied companies, their respective licensees, successors and assigns, the right to construct, operate and maintain a line of communication consisting of such poles, wires, cables, conduits, guys, anchors and other necessary appurtenances as from time to time are required upon, across, over and/or under that certain tract of land situated in Greenville, County, State of South Carolina, to-wit: THAT TRACT OF LAND BOUNDED ON THE EAST BY EDNA MARIE BROCK AND ON THE NORTH BY U.S. Highway I-85 AND ON THE WEST BY SELMAN HARRIS.

and upon, along and under the roads, streets, or highways adjoining or through said property with the right to permit the attachment of and/or carry in conduit wires and cables of any other person or company for communications purposes or for the transmission and distribution of electric power and the right of ingress and egress to said premises at all times for the purpose of inspecting and maintaining said line and with the right to clear and keep cleared all trees, undergrowth or other obstructions within a strip of land (10) TEN feet on each side of the center of said line and to trim and cut and keep trimmed and cut all dead, weak, leaning or dangerous trees which might reach said line in falling; including the right to relocate said line on said premises to conform to any future highway relocation, widening or improvement; the said sum being received in full payment for the rights herein granted.

The Company agrees to relocate at its own expense, on said property, its lines and fixtures to conform with future building improvements.

Signed, sealed and delivered in the presence of:  
 Executed December 12th, 1959  
 J. H. Ferguson (Signature)  
 Mrs. Myrtle Pickens (Signature)  
 F. C. Pickens (SEAL)  
 Mrs. Myrtle Pickens (SEAL)  
 Myrtle Curton  
 NEE: ~~Myrtle~~ MYRTIE CURTON

GEP 47.101 ACKNOWLEDGMENTS For Use in South Carolina Individual Form Form 8425 Nov. '54

STATE OF SOUTH CAROLINA }  
 COUNTY OF Greenville } ss.

Personally appeared before me John H. Ferguson  
 and made oath that (he) (she), with MYRTIE PICKENS saw the within named  
 F. C. PICKENS AND MYRTIE CURTON PICKENS

sign, seal, and deliver as (his) (her) (their) act and deed the within written instrument, and that (he) (she) with the said MYRTIE PICKENS witnessed the execution thereof.

Sworn to before me this 11 day of March A.D. 1960  
 John H. Ferguson (Signature)  
 Notary Public Recorded March 30, 1960 at 10:34 A.M. # 26632