

This is not a subdivision of land as defined by adopted regulations of the Greenville County Planning Commission. No parcel shown contains less than 5 acres and no new roads are involved.

GREENVILLE COUNTY  
PLANNING COMMISSION  
18 THOMPSON STREET  
GREENVILLE, S. C.

*Bert G. Whitehall*  
Director of Planning

DEC 12 1967

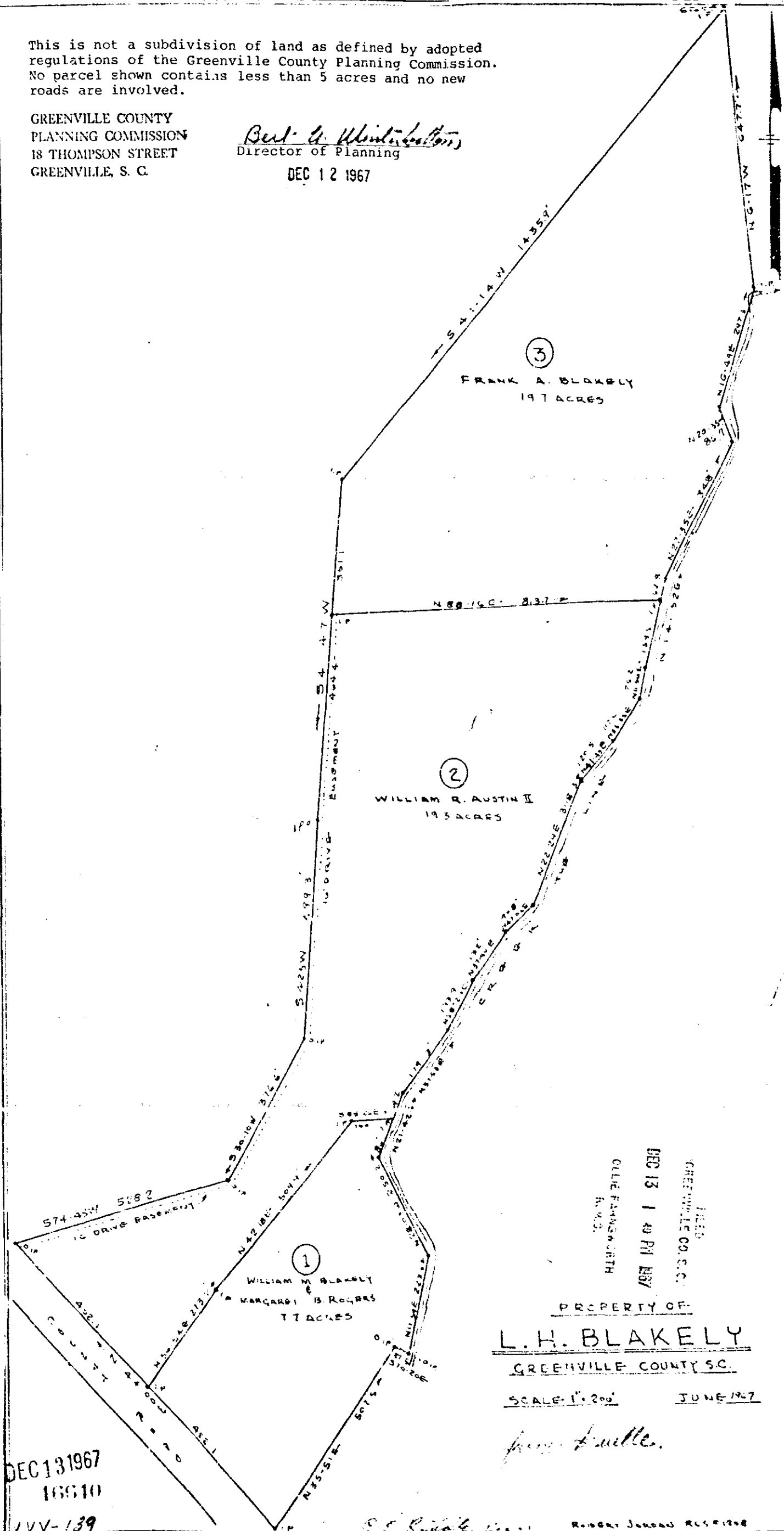

*# 14640 Filed 12/13/67*  
And Record *Vol. 141 p. 139*  
*Oliver Farm with*  
Register Map of Greenville County, S. C.

FIELD  
GREENVILLE CO. S. C.  
DEC 13 1 40 PM 1967  
OLIVER FARM WITH  
A. W. S.

PROPERTY OF  
**L. H. BLAKELY**  
GREENVILLE COUNTY S. C.

SCALE: 1" = 200' JUNE 1967

*from Smith.*

DEC 13 1967  
16610  
VVV-139

ROBERT JORDAN RLS #1208