

FEB 1 5 01 PM '72

OLLIE FARNSWORTH
R. M. C.

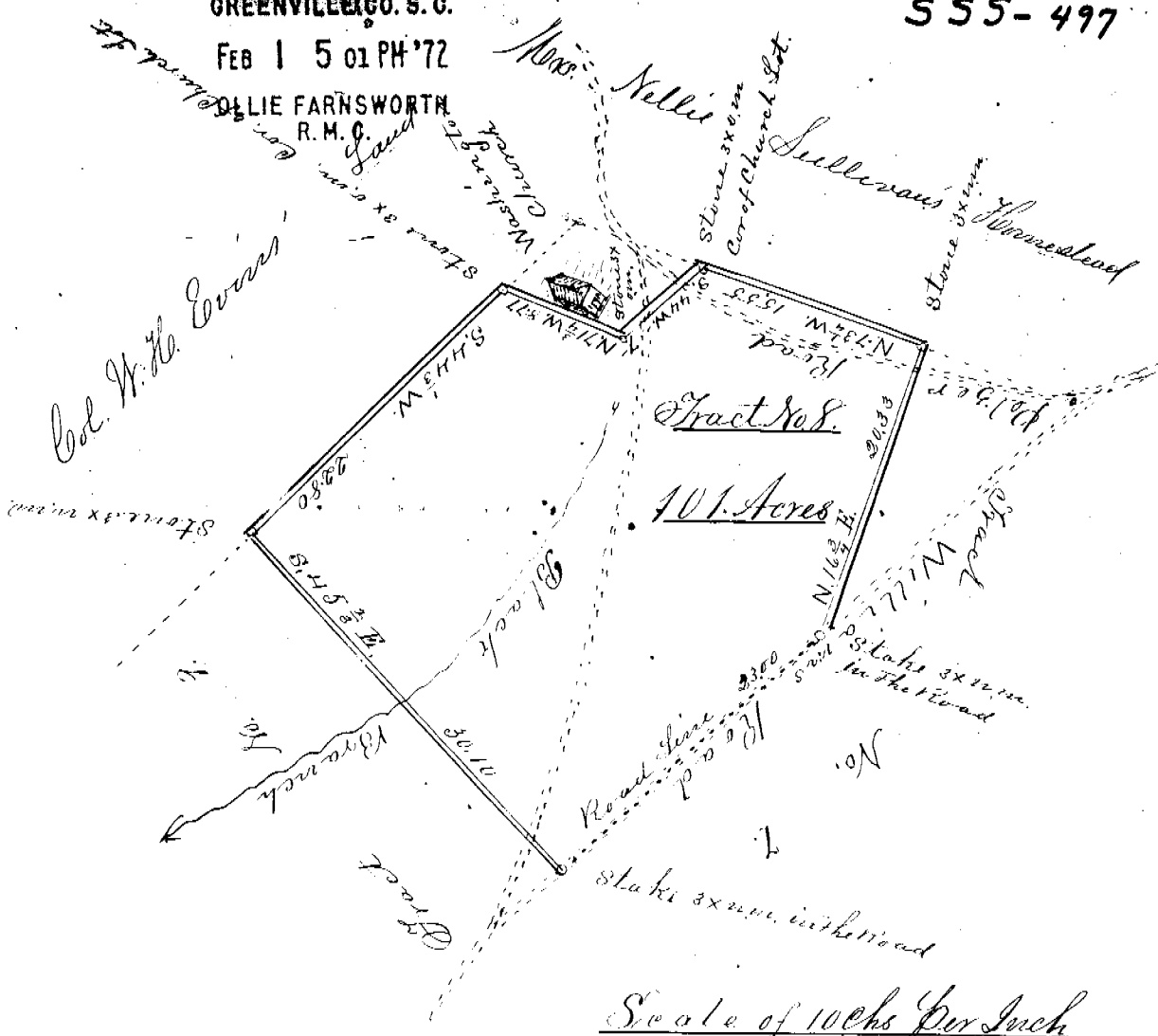

Scale of 10chs per Inch

The State of South Carolina }
 County of Greenville } Pursuant to the
 direction of the Com-
 missioners appointed to partition a certain
 tract of land belonging to the Estate of Mrs. Mary
 Ware, deceased, lying on both sides of the Augusta
 road sixteen miles below Greenville Court House,
 I have surveyed said tract of land, the same being
 a consolidation of various tracts and parts of
 tract formerly owned by Adam Jones, deceased,
 and containing, in the aggregate, 1719 acres.
 I have also divided said lands into fourteen
 separate tracts for partition and sale, as will
 fully appear from a General Map of the same.
 The above plat represents Tract No. 8 containing 101 acres.
 Resurveyed and divided the 2nd day of Jan. 1884
 J. N. Southworth
 D. S.