

#7902 Filed This 14th day of Sept. 1967
 And Recorded in Vol. R.R. Page 161 at 11:46 A.M.
 Ollie Farnsworth
 Register Mesne Conveyance Greenville County, S. C.

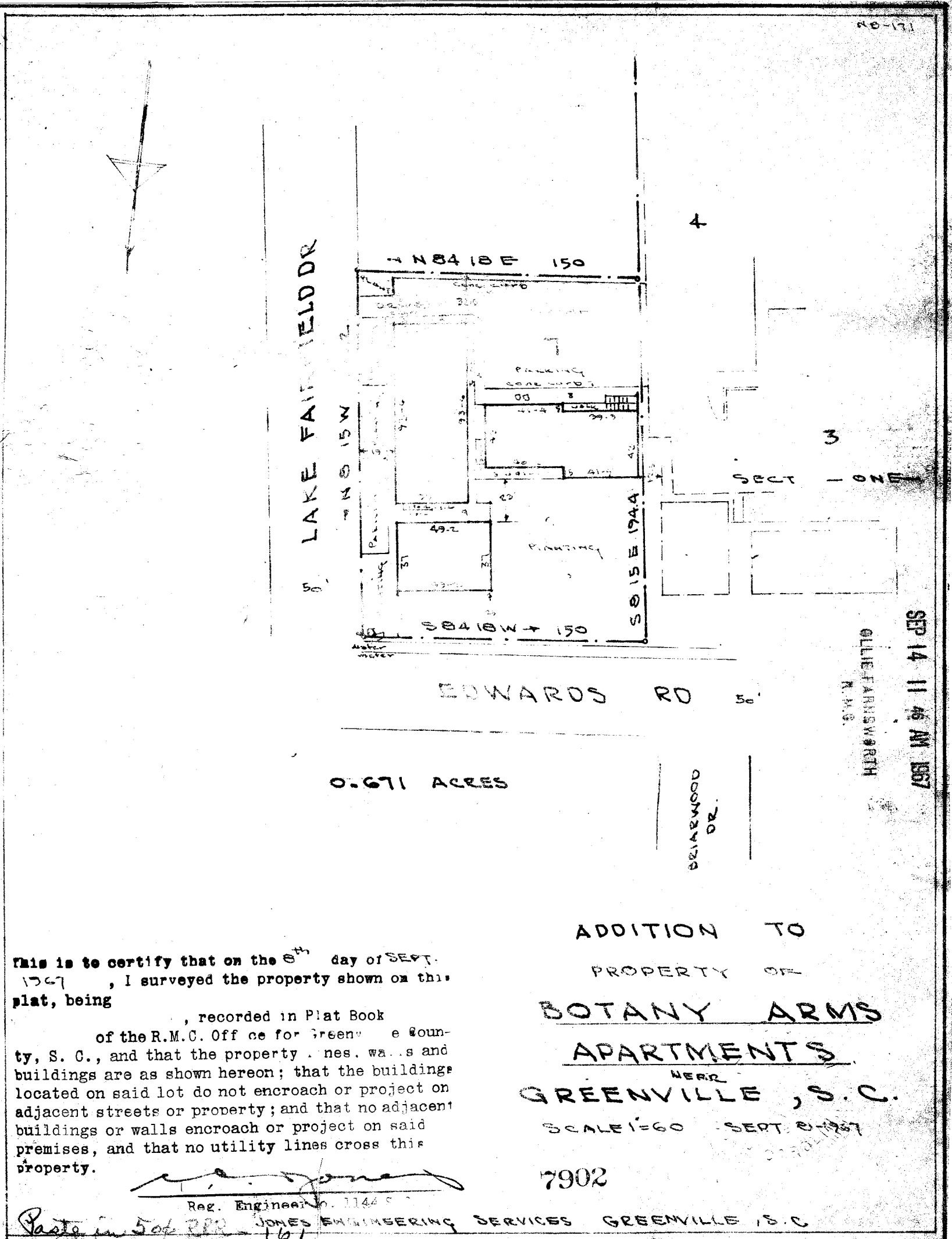

This is to certify that on the 14th day of SEPT. 1967, I surveyed the property shown on this plat, being

0.671 ACRES, recorded in Plat Book of the R.M.C. Office for Greenville County, S. C., and that the property lines, walls and buildings are as shown hereon; that the buildings located on said lot do not encroach or project on adjacent streets or property; and that no adjacent buildings or walls encroach or project on said premises, and that no utility lines cross this property.

ADDITION TO
 PROPERTY OF
BOTANY ARMS
APARTMENTS
 NEAR
GREENVILLE, S. C.

SCALE 1"=60' SEPT. 8-1967
 7902

[Signature]
 Reg. Engineer No. 1144
 JONES ENGINEERING SERVICES GREENVILLE, S. C.
 Paste in 506 R.R. - 161