

ROPER Mtn. Rd.

-BALENTINE-

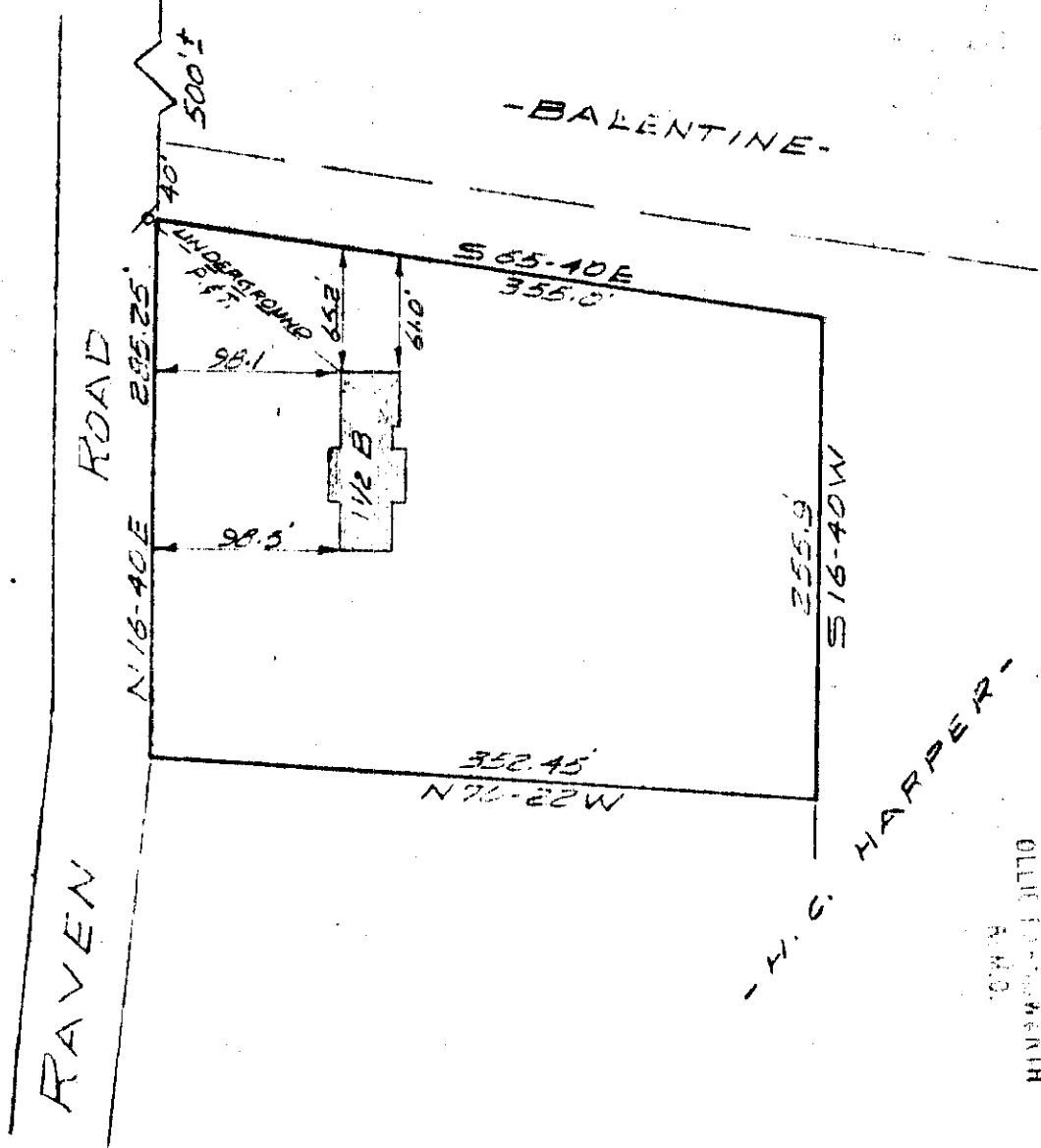
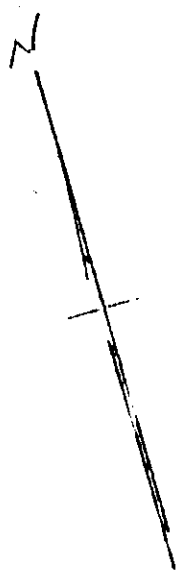

-H.C. HARPER-

OLIVER B. HARRIS
S.A.M.

JAN 27 2 27 PM 1966

GREENVILLE CO. S.C.

PROPERTY OF
ANTONY C. HARPER
 NEAR GREENVILLE, S.C.
 SCALE 1"=100' JAN. 7, 1966

This is to certify that on the 7 day of January 1966, I surveyed the property shown on this plat; and that the property lines, walls and buildings are as shown hereon; that the buildings located on said lot do not encroach or project on adjacent streets or property; and that no adjacent walls or buildings encroach or project on this lot; and that there are no utility lines crossing this property except as shown.

JAN 27 1966
 21964

Douglas S. Crouch
 Douglas S. Crouch
 Registered Engineer No. 962

PIEDMONT ENGINEERS AND ARCHITECTS
 GREENVILLE, S. C.



LLL - 73 504

5635

21964 Filed This 27 day of Jan 1966
 And Recorded in Vol. 588 Page 173 at 2:27 P.M.
Carla Harwood
 Register Mesne Conveyance Greenville County, S. C.