

WILLIAMS PROPERTY
← N. 73-45W 866.2 FL.

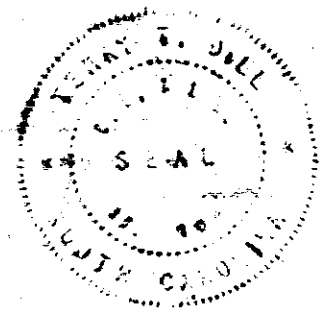
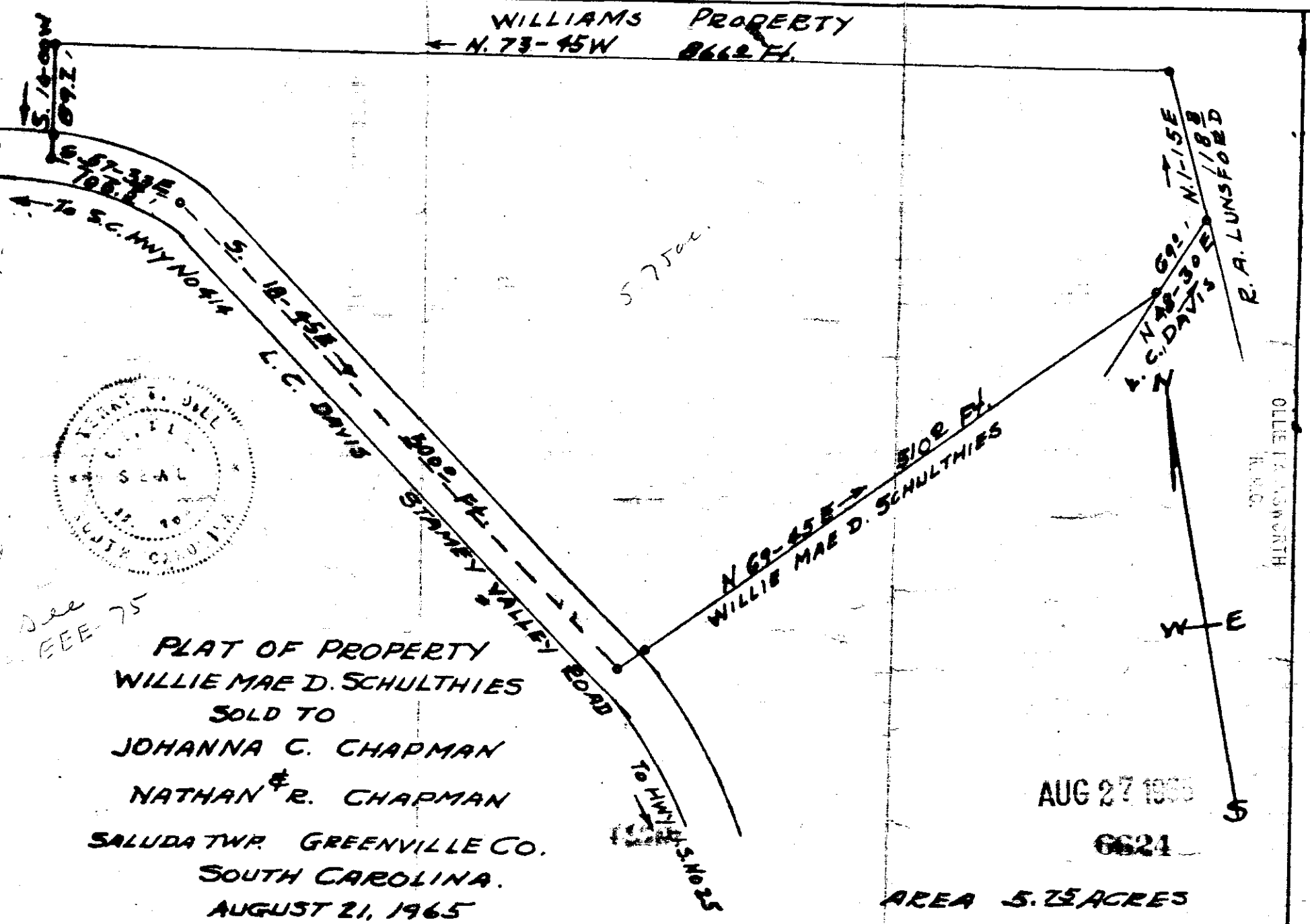

See Fee-75

PLAT OF PROPERTY
WILLIE MAE D. SCHULTHIES
SOLD TO
JOHANNA C. CHAPMAN
&
NATHAN R. CHAPMAN
SALUDA TWP. GREENVILLE CO.
SOUTH CAROLINA.
AUGUST 21, 1965

By Terry T. Dill
Reg. C.E. & L.S. No 104.

5.75 ac.

WILLIE MAE D. SCHULTHIES
N 62-45E 510.2 FL.

R. A. LUNSFORD
Z. C. DAVIS
N 71-5E 118.8

OLLE L. LUNSFORD
R.A.C.

AUG 27 12 30 PM 1965

AUG 27 1965

6624

AREA 5.75 ACRES

SCALE 1" = 100'
Boundary Survey 8-30-61

Filed This day of Aug 19 65
And Recorded in Vol. KKK Page 109 at 12:13 P.M.

[Signature]
Register Mesne Conveyance Greenville County, S. C.

KKK 109 - Part in 5 of