

BROADUS AVE.

N 13 3 5 7 0 North St.  
N 15-56 W 60'

IP. 1 P.S. 5' from corner

IP. old 1 P.S. 5' from corner

N 76-00 E 133.65'

S 76-00 W 134.15'

ALLEY

S 16-24 E 60'

IP. old

15'

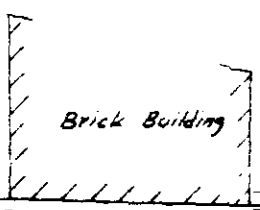

Brick Building

nail in concrete wall

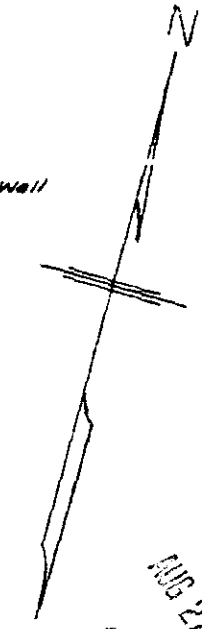

FILED  
GREENVILLE CO. S. C.  
AUG 27 11 10 AM 1962  
OLLE [unclear] NORTH  
P. 216

AUG 27 1962  
5554  
Riddle [unclear]  
504  
AAA-165

PROPERTY OF  
E. RANDOLPH STONE  
GREENVILLE S. C.  
SCALE 1"=20'  
AUG. 22, 1962

C. C. Riddle - Reg. L.S. # 1347

5554... filed this 27 day of AUG 1962  
and recorded in [unclear] Page 165 of [unclear]

*[Signature]*  
Register Meane (Greenville) Greenville County, S. C.

B. C. 62