

The Greenville City Water Works has no objections to the recording of this plat with no definite easement width being indicated on the plat.

J. L. Hawkins
J. L. Hawkins, General Manager

FILED
GREENVILLE CO. S. C.

NOV 24 9 30 AM 1962

OLLIE FARNSWORTH
R.M.C.

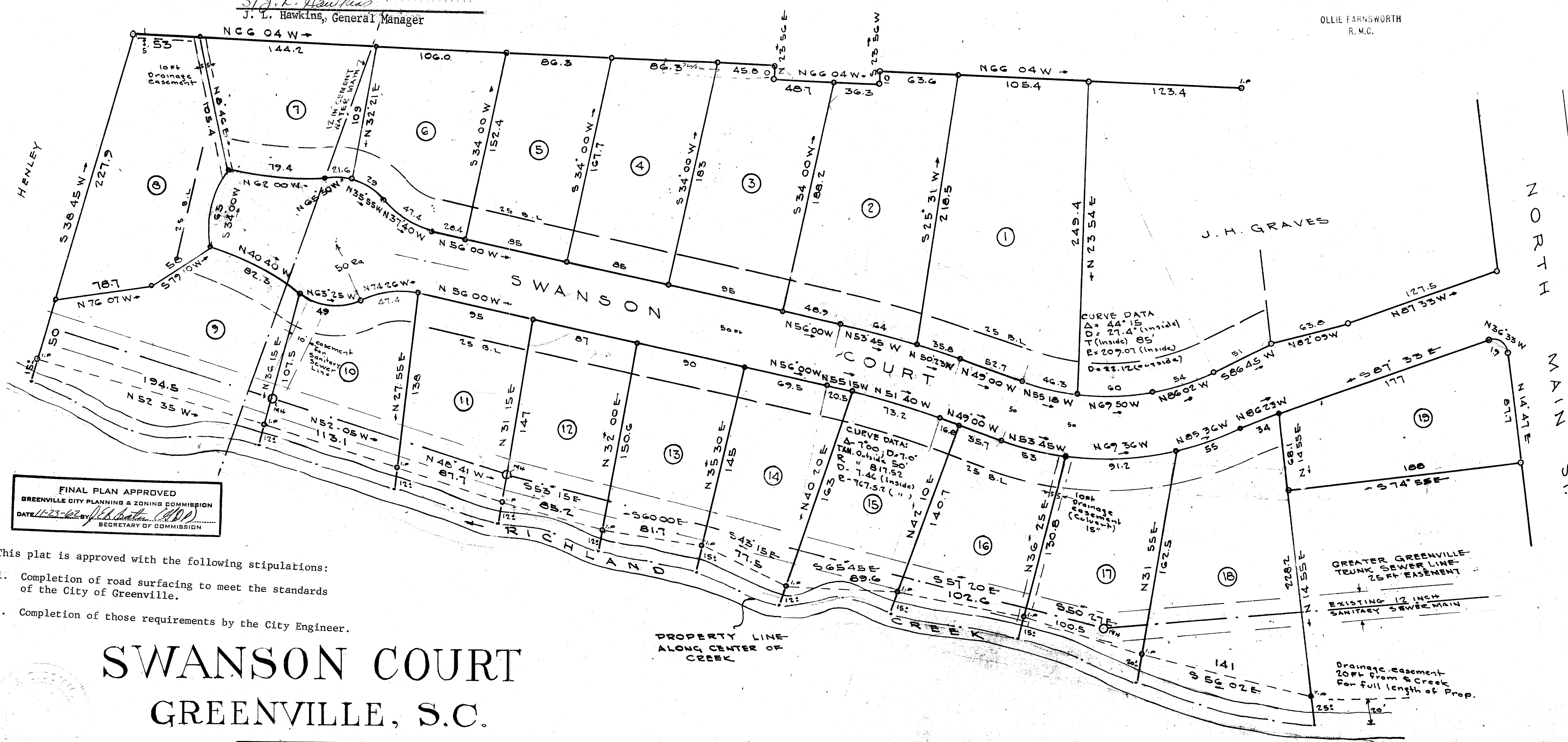

FINAL PLAN APPROVED
GREENVILLE CITY PLANNING & ZONING COMMISSION
DATE 11-23-62 BY *[Signature]*
SECRETARY OF COMMISSION

- This plat is approved with the following stipulations:
1. Completion of road surfacing to meet the standards of the City of Greenville.
 2. Completion of those requirements by the City Engineer.

SWANSON COURT GREENVILLE, S.C.

SCALE 1" = 50'

13569
NOV 24 1962
YY-91 2.50

DEVELOPED BY
MAULDIN CONSTRUCTION CO.
GREENVILLE, S.C.

NOTE: 5ft. drainage easement along all side and rear prop. lines, unless otherwise shown or noted.

CERTIFICATE OF SURVEY	CERTIFICATE OF OWNER
I hereby certify that this is an accurate map of an actual survey completed by me on NOVEMBER 1962	I hereby certify that I am the owner of property shown on this map and do approve of the subdivision thereof as shown.
<i>[Signature]</i> Registered Engineer S.C. 1144	<i>[Signature]</i> Address: Date: NOV 1962

NOTE: This Plat is a revision of one on record and Dated APRIL-1962

13569 Filed This 24 day of Nov. 1962
And Recorded in Vol. 44 Page 91 at M.
[Signature]
Register Mesne Conveyance Greenville County, S. C.

91