

SCALE: 10 CHAINS PER INCH

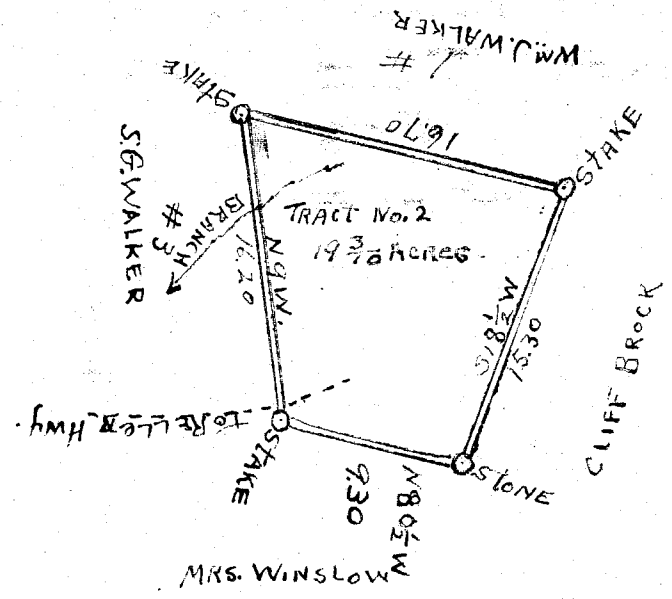

State of South Carolina  
 County of Greenville  
 Lands of the estate of the late  
 Josephine Walker.  
 Tract no. 2, allotted to Lillie Clayton  
 situate in Oaklawn Township, State  
 and county aforesaid  
 Form, marks, area, metes and bounds  
 as shown

March, 22, A.D. 1938  
 W. Adams  
 B. F. Wigginton  
 Surveyors

FILED THIS 7 DAY OF April 1938  
 AND RECORDED IN VOL. 2 PAGE 98.  
 Ollie Jamieson  
 Register Meane Conveyance  
 Greenville County, S. C.

# 4478