

- DUNCAN -

FILED
GREENVILLE CO. S. C.
JUL 30 2 57 PM '86
DONNIE S. TANKERSLEY
R.M.C.

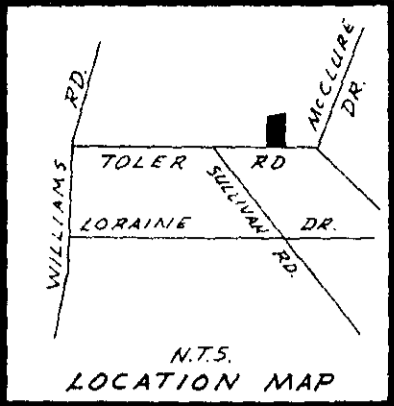

NOTE:
THIS PART OF LOT 53 AS
SHOWN ON PLAT OF MEADOW
BROOK FARMS.
PLAT BOOK M PAGE 105,
DEED BOOK 1141, PAGE 564.

SUTTON
PT. 52

PT. 53

WALDROP
54

622' ± TO
WILLIAMS ROAD

N 3 - 00 E 217.4'

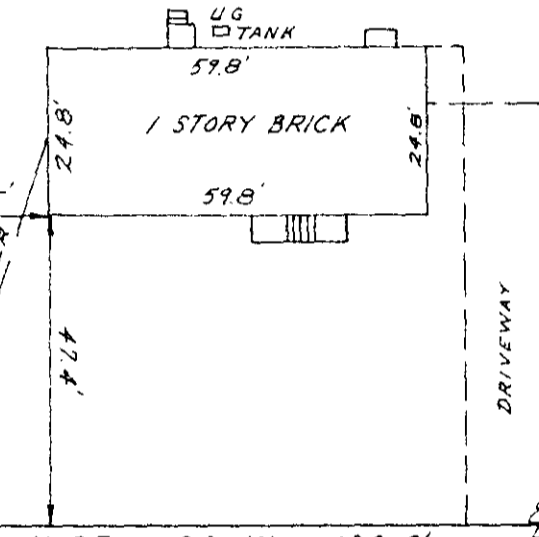

N 87 - 00 W 100.0'

TOLE R ROAD



SURVEY FOR
DANIEL BALLEW, JR.
SUSAN K. BALLEW
CITY OF TRAVELERS REST GREENVILLE COUNTY
SOUTH CAROLINA
MAY 29, 1986

4299 ✓
12-2-34

JUL 30 1986

To The Best Of My Knowledge This Structure
Is Not In An Established Flood Zone.

I Herby Certify That The Measurements As
Shown Above Are Correct And There Are No
Encroachments Or Projections Other Than
Shown.

I Herby Certify That The Ratio Of Precision
Of The Field Survey Is 1/5000 As Shown
Hereon And The Area Was Determined By Computer.

JEFFERY M. PLUMBLEE, INC.
LAND SURVEYING

P O BOX 788
TRAVELERS REST S C 29690

(803) 834-4426

496 - 2 - 49

Jeffery M. Plumblee
P.L.S. # 7881

SCALE 1" = 30'

FB. 36

SCALE 1" = 30'

5 OCT

2 JUL 30 86 205