

FILED
GREENVILLE CO. S.C.
JAN 11 2 05 PM '85
DONNIE S. TANKERSLEY
R.M.C.

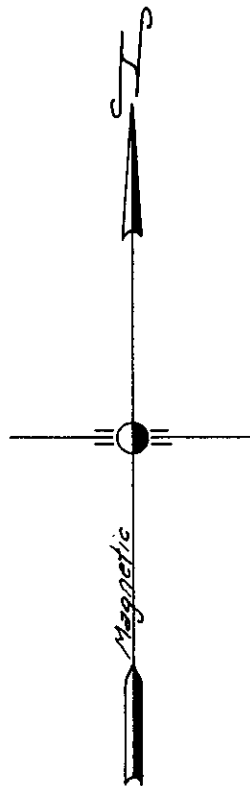

G6-3-3

N. 63° 15' E. 275.92'
269.28'
S. 63° 15' W.

G6-3-13

N. 63° 15' E. 142.00'

S. 48° 26' E. 172.05'

0.74 ACRE

Out of Tax Map G6-3-13

N. 48° 26' W. 180.88'

S. 69° 42' W. 149.64'

G6-3-13

G6-3-13

20662 ✓

JAN 11 1985

11-7-9

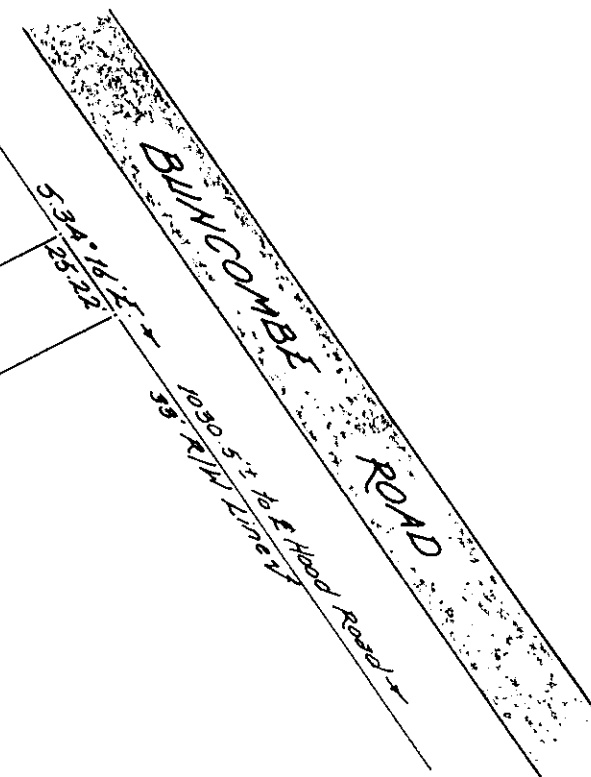

LOCATION MAP

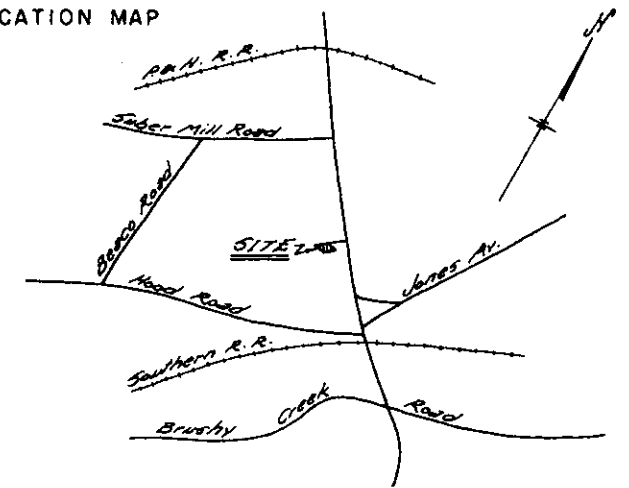

(No Scale)

- IRON PIN, NEW
- IRON PIN, OLD
- △ NAIL & CAP
- ◊ STONE, OLD
- R.R. SPIKE
- MONUMENT

I hereby certify that the ratio of precision of the unadjusted field survey is 1/5000 as shown hereon and the area was determined by the coordinate method of calculation; monuments are as noted hereon.

I hereby certify the measurements as shown are correct and that there exists no obvious encroachments or projections, except as shown.

This property is subject to all easements, zoning ordinances, and/or rights of way, of record or not of record

2212
R.L.S. NO.

Jan. 10, 1985
DATE



PROPERTY OF
W. PALMER DILLARD

SURVEYED FOR
W. LEMUEL DILLARD

GREENVILLE COUNTY, SOUTH CAROLINA

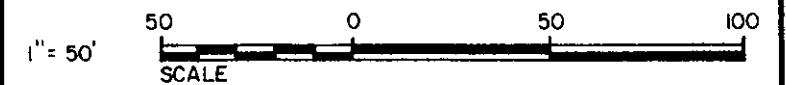

DRAWN T.L.M.	FIELD J.R.S.	DATE JAN. 9, 1985	JOB NO. 850109
-----------------	-----------------	----------------------	-------------------



Tri-State Surveyors
109 Few Street
Greer, South Carolina

REPROGRAPHIC CONSULTANTS, INC.

JAN 11 1985 834

5.00CI

MICROFILMED