

MICROFILMED

FILED
GREENVILLE CO. S.C.

Note:

In accordance with Nov 5 1 59 PM '84
Greenville County
First Floodway Maps
165 of 325 Panel
No. 450089 - 0165 A
the improvements on
this lot are not in
a flood hazard area.

DONNIE S. TANKERSLEY
R.M.C.

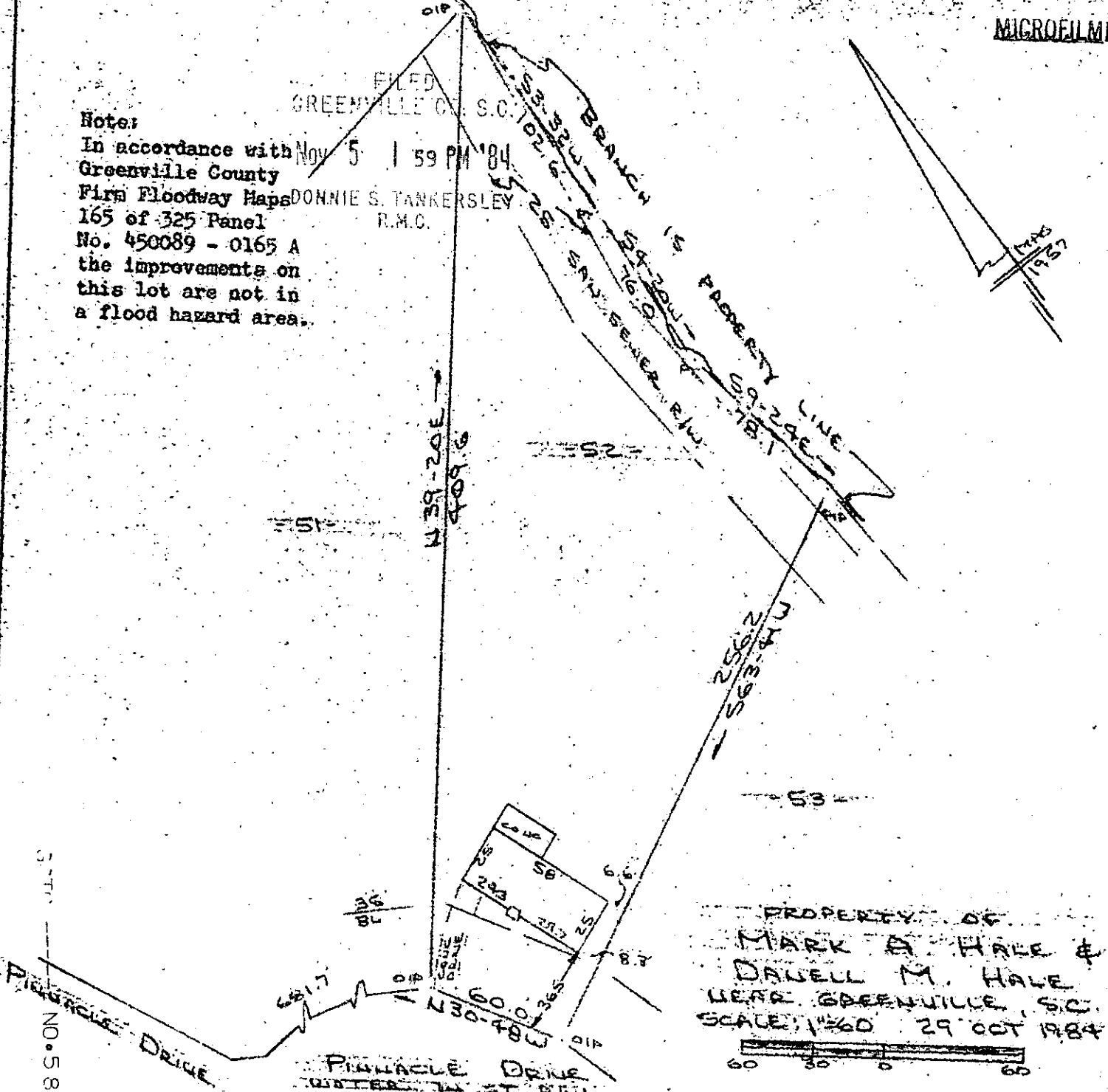

PROPERTY OF
MARK A. HARRIS &
DALELL M. HALE
NEAR GREENVILLE, S.C.
SCALE 1"=60' 29 OCT 1984

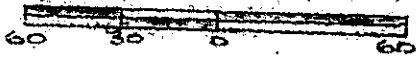

This is to certify that on the 29th day of October, 1984, I surveyed the property shown on this plat, being known as lot 52 on plat of SECTION "C" GREEN FOREST and recorded in the RMC Office Greenville County, S. C., in Plat Book "KK" at Page 87; and that the property lines, walls and buildings are as shown hereon, and that the walls and buildings located on said lot do not encroach or project on adjacent street or property, and that no adjacent walls or buildings encroach or project on said premises, and no power lines cross this property except as shown hereon.

13708

NOV 5 1984

11-A-95

R. B. Bruce
R. B. Bruce, RLS # 1952

3.00CI

CAROLINA
112

SURVEYING
Manly St., Greenville, S.C.

CO. Recordable Plat