

MICROFILMED

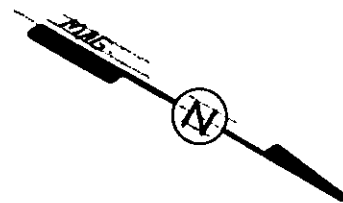

This is to certify that on July 18, 1983, I surveyed the property shown on this plat, known as Pt. Lot 4 on the plat of Clairmont Ridge, recorded in the RMC Office of Greenville County in Plat Book H on page 182 and that the property lines, walls and buildings are as shown hereon that the property located on said lot does not encroach or project on adjacent streets or property and that no adjacent walls or buildings encroach or project on said premises, and that no utility lines cross this property except as shown hereon. This property is not located in a designated flood hazard area.

James R. Freeland
James R. Freeland
R.L.S. & P.E. 4781

JUL 29 1983

9-V-88

3462 ✓

PART LOT 4

N 22-40 W 81.52

PART LOT 4

PART LOT 4

LOT 3

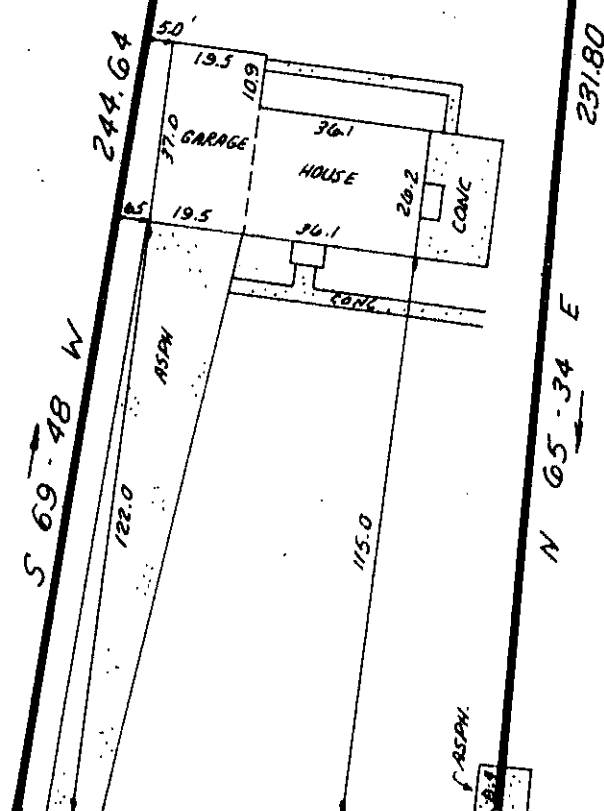

S 29-59 E 100.0 53' RR. SPIKE NEW

PINEY MOUNTAIN ROAD



FILED
GREENVILLE CO. S.C.
JUL 29 11 20 AM '83
DONNIE S. TANKERSLEY
R.M.C.

STATE OF SOUTH CAROLINA
GREENVILLE COUNTY

CLAIREMONT RIDGE
PART LOT 4
PROPERTY OF
ROBERT L. MITCHELL
SHERI S. MITCHELL

FREELAND & ASSOCIATES
Engineers • Land Surveyors

GREENVILLE, S.C.

SURVEY	J.E.C.
DRAWN	K.E.G.
CHECK	M.C.
SCALE	1" = 40'
DATE	7-15-83
DWG. NO.	9352

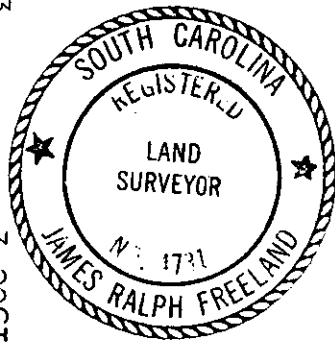

SEAL

THE PRINT MACHINE, INC. N300331