

MICROFILMED

Note: Improvements on this lot are not in a flood hazard area.

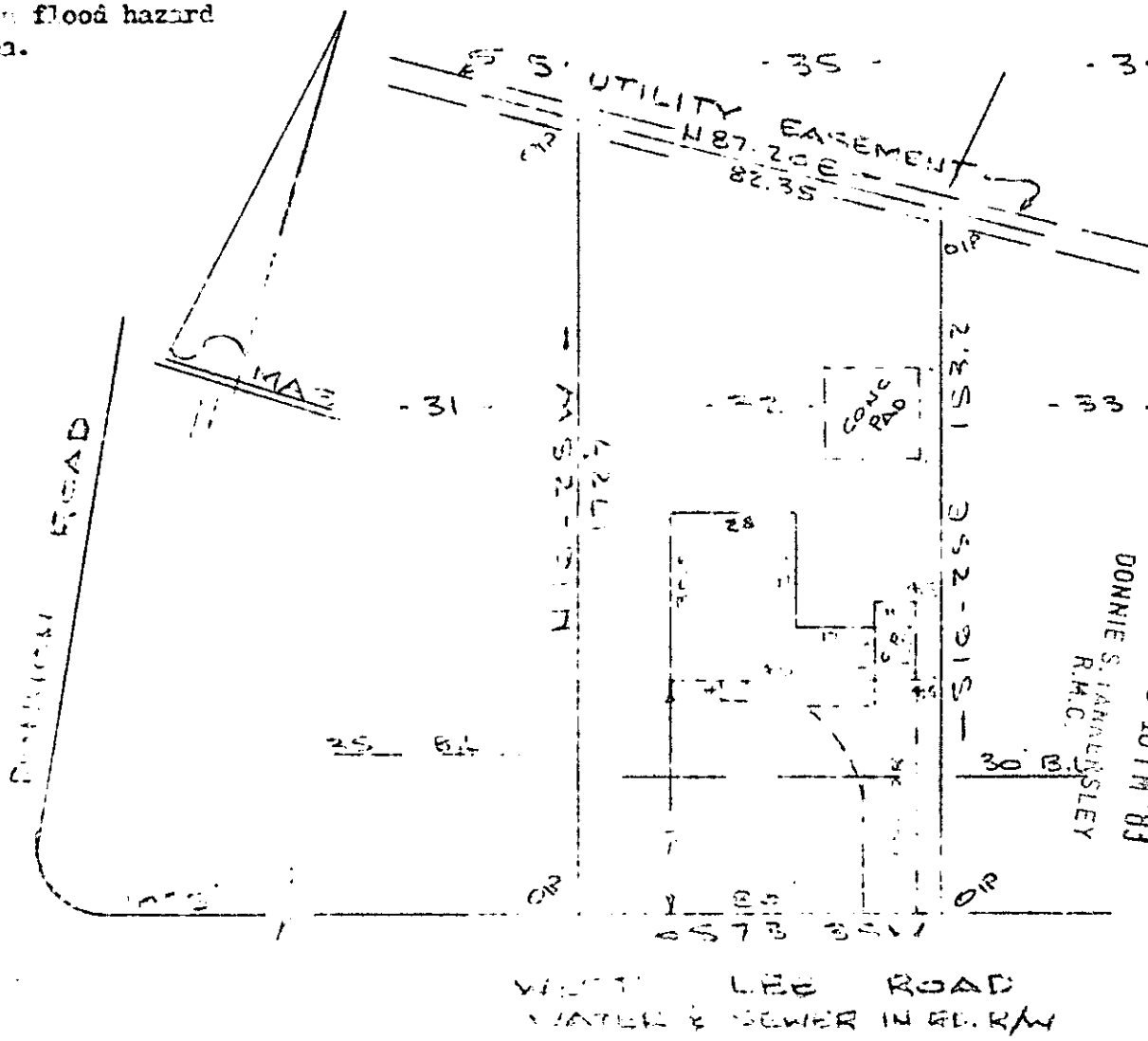

FILED
 GREENVILLE CO. S.C.
 JUN 1 3 10 PM '83
 DONNIE S. JARVIS
 R.M.C.

VICTOR LEE ROAD
 WATER & SEWER IN R.R.W.

PROPERTY OF
 FRANCIS GERALD McDONALD & BRENDA G. McDONALD
 NEAR GREENVILLE, S.C.
 40 24 MAY 1983 40

This is to certify that on the 24th day of May, 1983, I surveyed the property shown on this plat, being known as lot 32 on plat of MAP OF SUPER HIGHWAY HOME SITES and recorded in the 433 Office Greenville County, S. C., in Plat Book " P " at Page 53; and that the property lines, walls and buildings are as shown hereon, and that the walls and buildings located on said lot do not encroach or project on adjacent street or property, and that no adjacent walls or buildings encroach or project on said premises, and no power lines cross this property except as shown hereon.

9-T-73

32465

E. B. Bruce
 E. B. Bruce, RLS #1952

JUN 1 1983

CAROLINA SURVEYING
 112 Mainy
 Greenville, S. C.

CC.
 C.

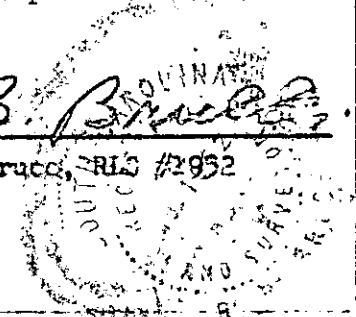

GCTO ----- 2 MY31 83 1133 3.00CI

225/1-A

PLAT 3-1-17

14120