

SUMMARY

CERTIFICATE OF APPROVAL FOR RECORDING

"I hereby certify that the subdivision plat shown hereon has been found to comply with the Subdivision Regulations for Greenville County and that it has been approved for recording in the office of the County Register of Mesne Conveyance."

DATE Aug. 26, 1982

Raymond Carter
DIRECTOR OF PLANNING
GREENVILLE COUNTY PLANNING COMMISSION

REC'D
GREENVILLE CO. S.C.
AUG 26 3 38 PM '82
S. TANKERSLEY
M.C.

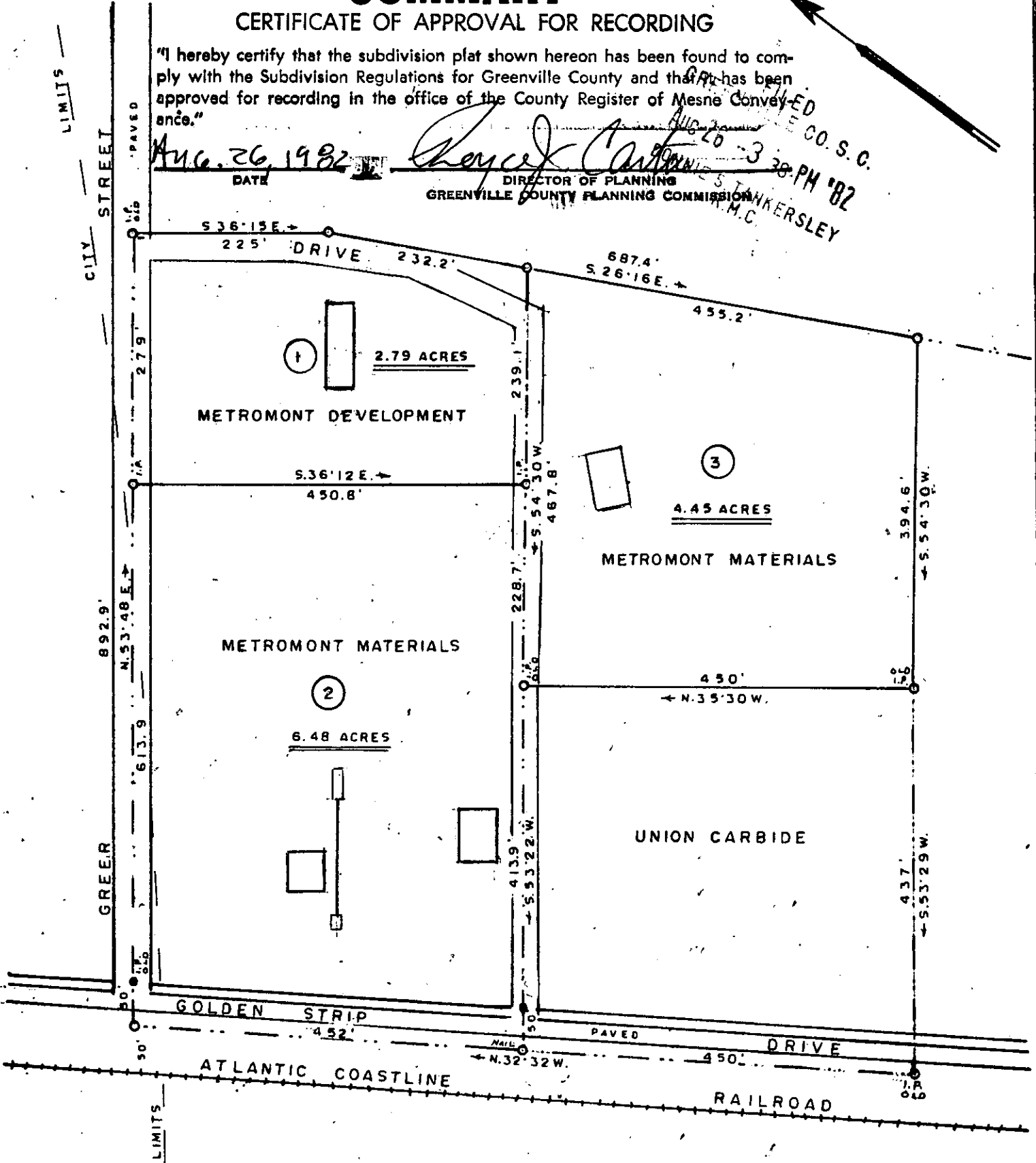
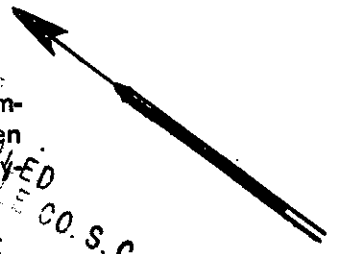

SURVEY FOR
METROMONT MATERIALS CORP.
AT CITY LIMITS OF MAULDIN
GREENVILLE COUNTY, S.C.

SCALE 1" = 150' MARCH 29, 1982

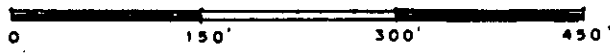

GOOCH & ASSOCIATES
SURVEYORS

9-E-64

4809

AUG 26 1982

THIS PLAT WAS COMPILED FROM PLAT FOR BALLARD-RICE PRESTRESSED CONCRETE CORP. BY PIEDMONT ENGINEERS & ARCHITECTS, DATED JUNE 3, 1963, AND A PARTIAL SURVEY BY US MARCH 29, 1982.

SIGNED

John S. Gooch

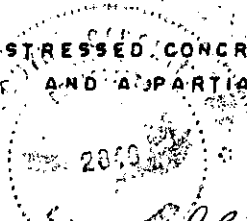

NOTED - 2 AUG 26 82 1501

3700CT