

WEST COFFEE STREET

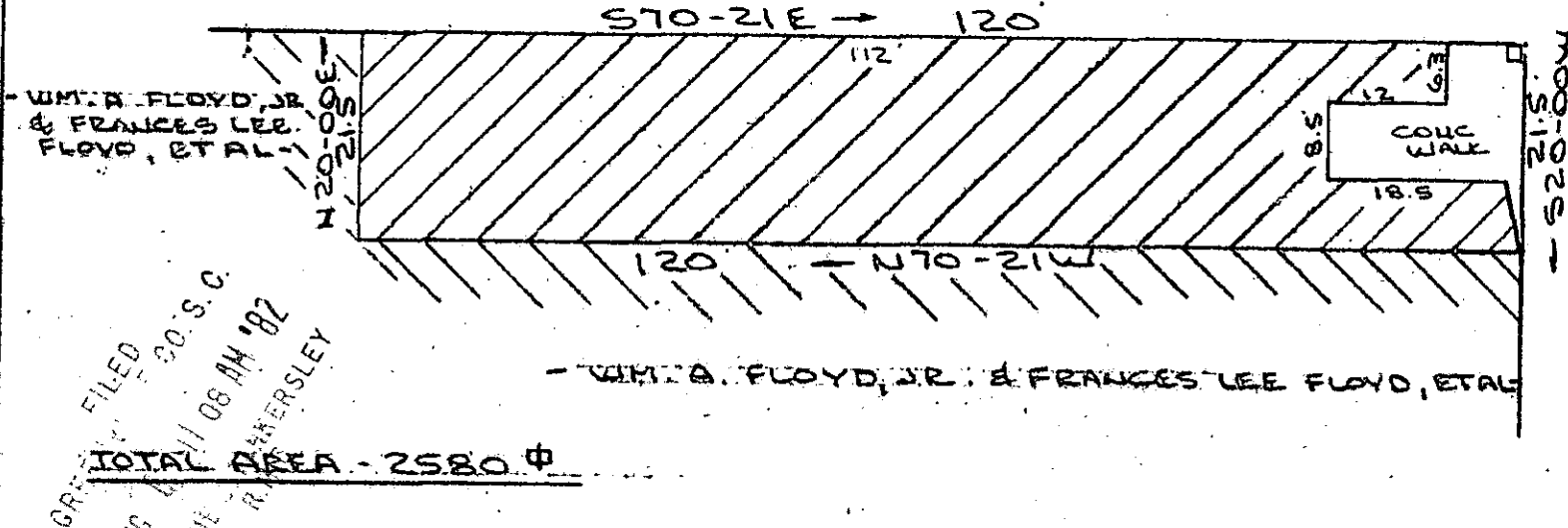

NORTH MAIN STREET  
WATER & SEWER IN ST. R/W

Note: Improvements on this lot are not in a flood hazard area.

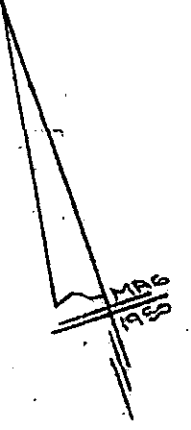

FILED  
AUG 11 08 AM '82  
DOHNER  
RIVERSLEY

TOTAL AREA - 2580.0

PROPERTY OF  
**WILLIAM J. BOUHAROUN & PATRICIA H. BOUHAROUN**  
GREENVILLE, S.C.  
SCALE: 1" = 20' 5 AUG 1982



This is to certify that on the 5th day of August, 1982, I surveyed the property shown on this plat, being known as PROPERTY OF WILLIAM J. BOUHAROUN & PATRICIA H. BOUHAROUN and recorded in the REC Office Greenville County, U. C., in Plat Book at Page ; and that the property lines, walls and buildings are as shown hereon, and that the walls and buildings located on said lot do not encroach or project on adjacent street or property, and that no adjacent walls or buildings encroach or project on said premises, and no power lines cross this property except as shown hereon.

3158  
P-E-22 ✓

*R. B. Bruce*  
R. B. Bruce, SLS #1952

AUG 6 1982

CAROLINA SURVEYING CO.  
112 Hanly St.  
Greenville, S.C.

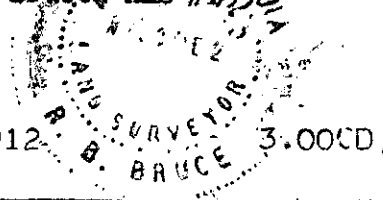

GCTO ---3 AU 6 82 012 3.00CD

RECORDED