

MICROFILMED

- S -

- 1 -

N 42-35E → 100'

FILED N 36-45E →

N 56-31E 91.0'

GREENVILLE CO. S.C.

AUG 1 2 41 PM '79

DONNIE S. TANKERSLEY
R.M.C.

SEPTIC TANK
ON LOT

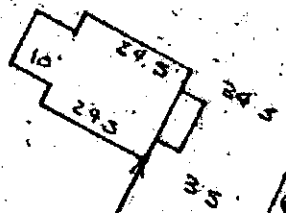

NOTE: Improvements on this lot are not in a flood hazard area.

- 6 -

S 42-35W 100'

200' TOT.

NFC 10 COLL.

BELVUE ROAD
WATER IN ST RW

PROPERTY OF
DORIS O. NELOMS
NEAR GREENVILLE S.C.
SCALE 1" = 40'

31 JULY 1979

This is to certify that on the 31st day of July, 1979, I surveyed the property shown on this plat, being known as lot 6 and unnumbered lot on plat of OLLIE B. BARRETT and recorded in the REC Office Greenville County, S. C., in Plat Book " 77 " at Page 485 and also being known as PROPERTY OF DORIS O. NELOMS and recorded in the REC Office in Plat Book at Page ; and that the property lines, walls and buildings are as shown hereon, and that the walls and buildings located on said lot do not encroach or project on adjacent street or property, and that no adjacent walls or buildings encroach or project on said premises, and no power lines cross this property except as shown hereon.

✓ 7-M-3

3936

R. B. Pinner

CAROLINA SURVEYING CO.
112 Hanly St., Greenville, S. C.

H. J. Bruce, REC #1952

LOCUST AVE WATER IN ST RW
N 52-25E
200'

GCTO 1-1-79

380

3.0001

113 #69

503 1-1-79