

1.35 MILES TO INTERSECTION OF WOODSIDE-SANDY SPRINGS RD.
WOODVILLE ROAD

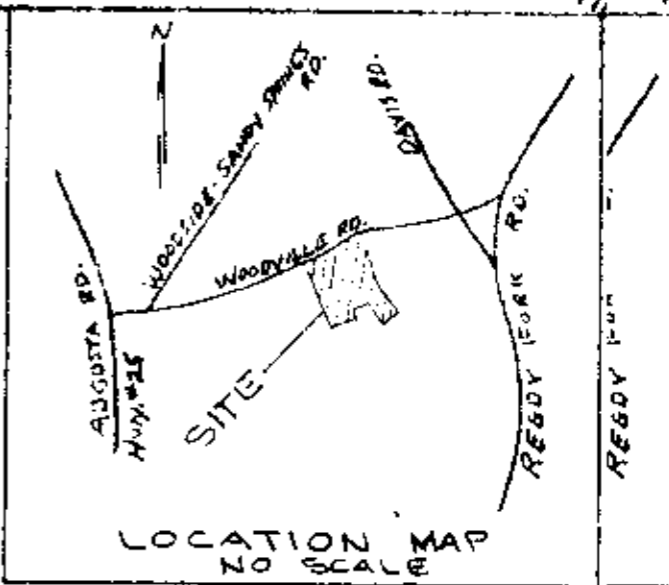

Magnetic North

GLENN R. KAY
 N 16-00 W
 2156.70

AMELIA MELTON COTHRAN
 N 44-10 W 665.0

N 62-38 E 1376.5'

S 44-10 E 1263.96'

ETHEL A. STUBBS

80.43 AC.

J. M. KING

H. DAVID CHANDLER
 S 48-35 W 1150.5'

670.3
 548-30 W

DENNIS F. COXER
 S 47-10 E 227.1

N 60-02 E 640.2

769.9'
 S 46-15 E

452.1
 S 61-00 E

BURRELL COXER

FILED
 GREENVILLE CO. S.C.
 MAR 16 3 24 PM '79
 DONNIE S. TANKERSLEY
 R.M.C.

FILED
 GREENVILLE CO. S.C.

NOTE: SURVEYED POINT "A" TO POINT "D" ONLY. INFORMATION FROM RECORDED PLAT BY OTHERS.

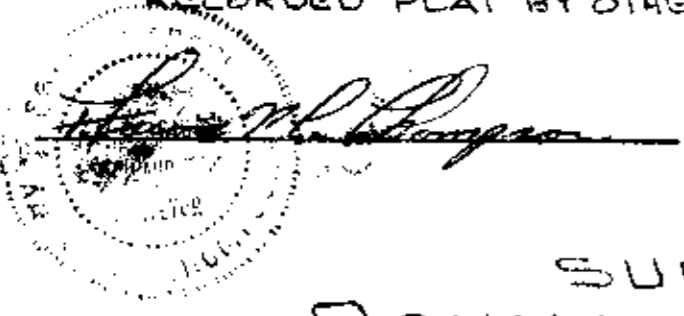

SURVEY FOR
DONNA MERCK JONES

GREENVILLE COUNTY, S.C.
 SCALE 1"=300' - 3-8-79

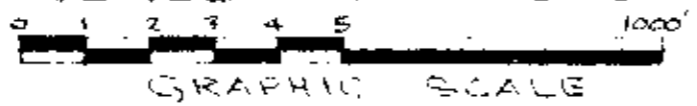

PIEDMONT SURVEYORS
 GREENVILLE, S.C. MAR 10 1979

#26525

7-A-18

BEARINGS & DISTANCES ON BEECO CREEK LINE			
1	N 11-10 W	68.4	
2	N 68-10 W	44.1	
3	S 1-50 E	66.1	
4	S 46-15 E	769.9	
5	S 61-00 E	452.1	
6	N 60-02 E	640.2	
7	S 47-10 E	227.1	
8	S 48-35 W	1150.5	
9	N 16-00 W	2156.70	
10	N 44-10 W	665.0	
11	N 62-38 E	1376.5	
12	S 44-10 E	1263.96	