

MICROFILMED

LOT 345

LOT 346

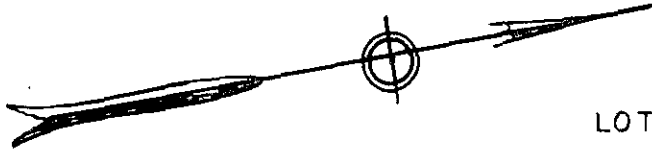

10Ft. Easement for Ingress & Egress

I.P. S10-30-53 W 133.68 I.P.

LOT 337
SECTION ONE
MAP NO. 3

LOT 338

S82-51-16E 151.59

N79-29-07W 150.04

LOT 336

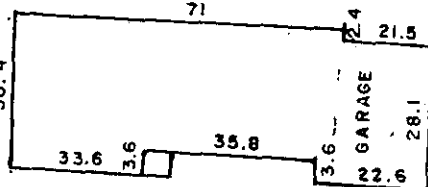

30' B.L.

374.96 I.P. 43.88 I.P. N8-49-49E N10-30-53E 81.12 I.P.

BRIAR CREEK ROAD

SILVER CREEK ROAD

PROPERTY OF
WILLIAM C. SEGREST
NANCY B. SEGREST
GREENVILLE CO., S. C.

FILED
GREENVILLE CO. S. C.
JUL 25 4 47 PM '75
DONNIE S. TANKERSLEY
R.M.C.

JUL 25 1975

Scale 1" = 40' July, 1975

This is to certify that on the 18th day of July, 1975, We surveyed the property shown on this plat; being known as Lot 337, Section One on Map No. 3 of Sugar Creek, Recorded in Plat Book 4R, page 86, Office of R. M. C. Greenville Co., S. C.; and that the property lines, walls and buildings are as shown hereon; that the buildings located on said lot do not encroach or project on adjacent streets or property; and that no adjacent buildings or walls encroach or project on said premises.

R. W. Dalton

2273

Dalton & Neves Co., Engineers

5M-126

RECORDING FEE
PAID \$ 00