

PROPERTY OF
MILFORD DON KELLY

MAULDIN, S. C.

SCALE: 1" = 60' AUGUST, 1974

RECORDING FEE
PAID \$ 1.00

Laura Elizabeth & Harry E. New

N51-28E 510.8'

S51-28W 473.8'

Wm. D. Yarborough & Lamar Kennedy

Ref.: Plat Of Property Of Nelle C.
Cooper; Survey By W. J. Riddle,
April, 1948.

14979

C. O. RIDDLE, REG.

DEC 18 1974

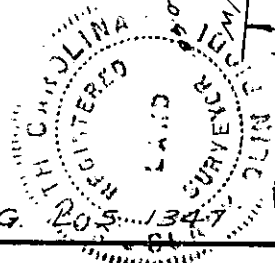

MICROFILMED

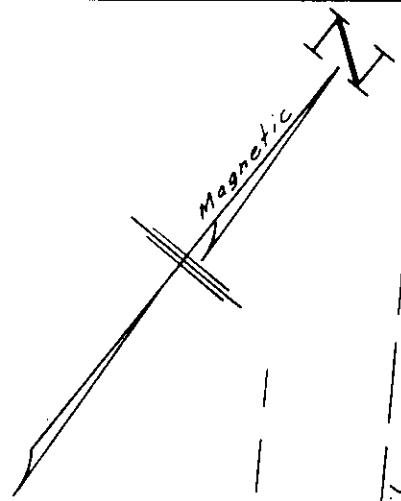

520.1' TO OWENS LANE
O.I.R.

U. S. HWY. NO. 276
N44-07W
200'

DOHNIE S. TANKERSLEY
R.M. 66

ATLANTIC COAST LINE RAILROAD

S33-29E
199.8'

50'

-9-

-10-

-11-

-12-

-13-

-14-

-15-

-16-

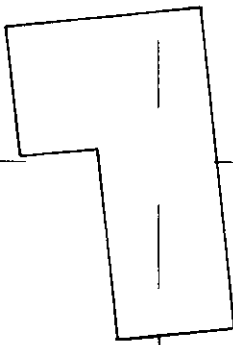
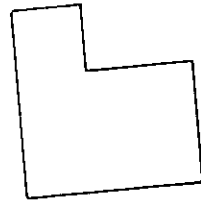

GREENVILLE CO. S. C.

DEC 18 11 50 AM '74

✓ 5K-2