

FILED
GREENVILLE CO. S. C.
OCT 31 4 30 PM '73
DORRIS STAMMERLEY
R.H.C.

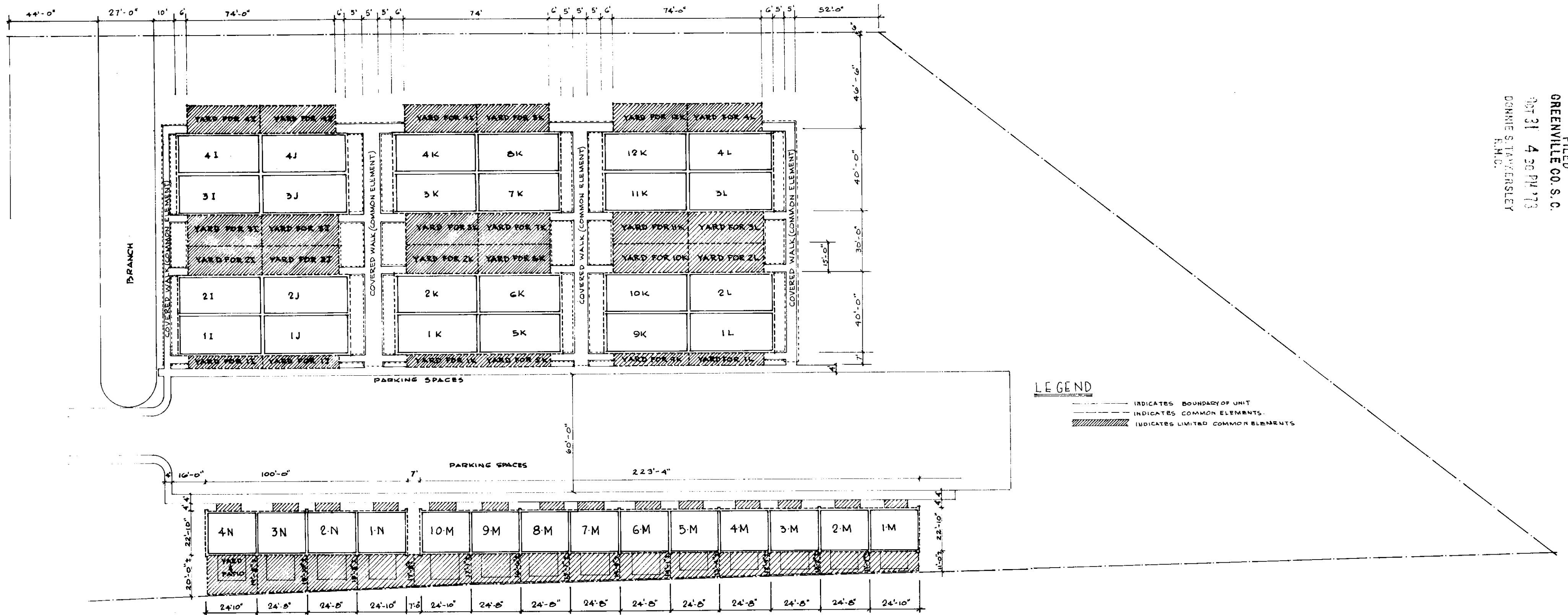

LEGEND

- INDICATES BOUNDARY OF UNIT
- - - - - INDICATES COMMON ELEMENTS
- ▨ INDICATES LIMITED COMMON ELEMENTS

1. ALL UNITS MARKED I, J, K & L ARE ONE STORY STRUCTURE WITH 2 BEDROOMS EACH UNIT. YARD DIMENSION AS SHOWN
2. BUILDINGS M & N SHOWN IN THIS PLAN ARE TWO STORY STRUCTURES WITH 3 BEDROOM UNITS DIMENSIONS SHOWN IN UNIT 4N ARE TYPICAL OF EACH 3 BEDROOM UNIT. YARD DIMENSIONS ARE SHOWN IN EACH CASE.
3. EACH UNIT CONSISTS OF THE SPACE BOUNDED BY THE UNDECORATED AND/OR UNFINISHED SURFACES OF THE PERIMETER WALLS, FLOOR & CEILINGS.
4. ALL INTERIOR ANGLES OF UNITS ARE 90°
5. PARKING SPACES LIMITED COMMON ELEMENTS NOT WITHSTANDING LEGEND AND SAID SPACES ARE FOR THE USE OF UNIT OWNERS; SPECIFIC PARKING SPACES TO BE ASSIGNED BY THE ASSOCIATION

#11996 Filed This 31 day of Oct 1973
And Recorded in Vol. 5 D Page 10 at 4:30 PM.
Dorris S. Stammerley
Register Mesne Conveyance Greenville County

5D-10

003103
#11996

Town Park of Greenville, S.C.

SHEET No. 2