

FOR DEDICATION OF ROADS SEE DEDICATION BOOK PAGE 198

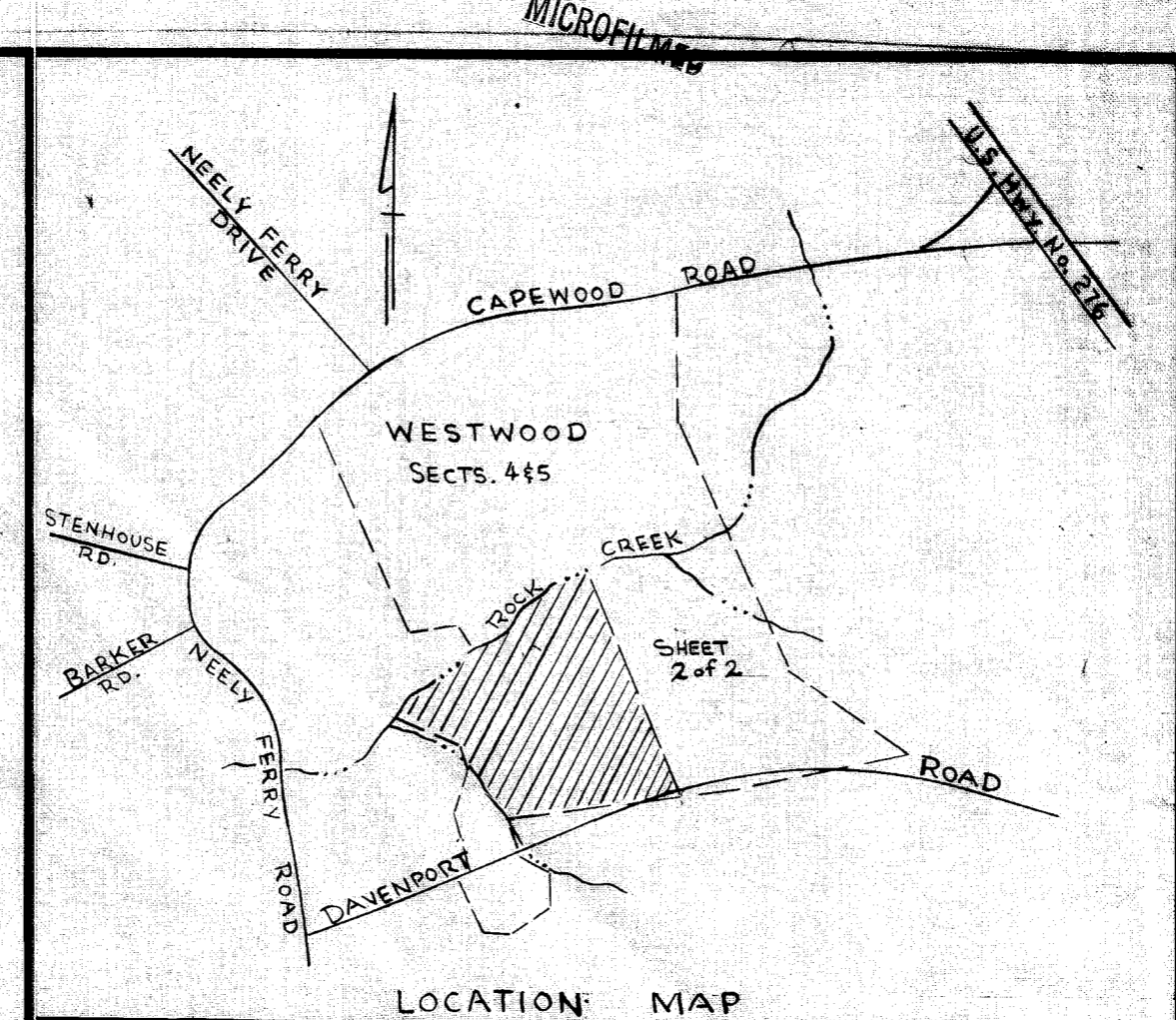

## FINAL PLAT

### CERTIFICATE OF OWNERSHIP AND DEDICATION

"The undersigned hereby acknowledge that I am (we are) the owner(s) of the property shown and described herein and that I (we) hereby adopt this plan of subdivision with my (our) free consent and that I (we) establish the minimum building restriction lines, and hereby dedicate to public use as roads, streets, and easements, forever all areas so shown or indicated on said plat.

Jan 7 1975 Signed [Signature]  
 \_\_\_\_\_ Signed \_\_\_\_\_  
 \_\_\_\_\_ Signed \_\_\_\_\_  
 \_\_\_\_\_ Signed \_\_\_\_\_

### CERTIFICATE OF ACCURACY

"I, James D. Cain, certify that this plat was (drawn by me) (drawn under my supervision) (an actual survey made under my supervision) from (an actual survey made by me) (deed description recorded in Book 940, Page 192, Book \_\_\_\_\_, Page \_\_\_\_\_, etc.) (other); that the error of closure as calculated by latitudes and departures is \_\_\_\_\_; that the boundaries not surveyed are shown as broken lines plotted from information found in Book \_\_\_\_\_, Page \_\_\_\_\_; that this plat was prepared in accordance with the Greenville County Subdivision Regulations as adopted.

12-30-74 DATE James D. Cain LICENSED ENGINEER OR REGISTERED SURVEYOR  
 S. C. Registration No. 3320

### CERTIFICATE OF APPROVAL FOR RECORDING

"I hereby certify that the subdivision plat shown herein has been found to comply with the Subdivision Regulations for Greenville County, with the exception of such variances, if any, as are noted in the minutes of the Greenville County Planning Commission of Greenville County, South Carolina, and that it has been approved for recording in the office of the County Register of Menses Conveyances."

JAN 7 1975 DATE J. Coleman Shouse DIRECTOR OF PLANNING  
 GREENVILLE COUNTY PLANNING COMMISSION

FILE NUMBER **73-173**

SHEET NO. 1 of 2  
**WESTWOOD**  
 SECTION VI

**BUILDERS & DEVELOPERS, INC.** OWNER  
**PIEDMONT ENGINEERS ARCHITECTS - PLANNERS** SURVEYOR

NO. OF ACRES: 43.64 MILES 1.15  
 NO. OF LOTS: 110 DATE: Nov. 18, 1974

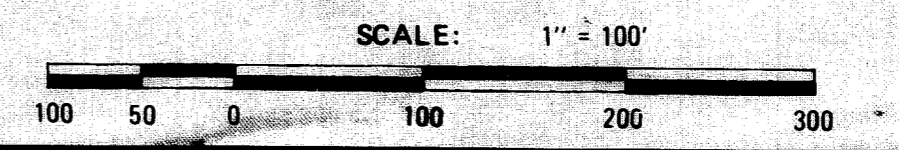

NOTE: 5' DRAINAGE & UTILITY EASEMENT EACH SIDE ALL 1/2" & REAR LOT LINES UNLESS OTHERWISE NOTED

4X-100

# 6557  
 RECORDING 5.00