

RECORDING FEE
PAID \$ 3.00

This is to certify that on the 6th day of April 1964, I surveyed the property shown on this plat, being known as RAMSGATE COUNTRY CLUB, Greenville County, S.C., and that the property lines, walls and buildings are as shown hereon, and that the buildings located on said lot do not encroach or project on adjacent street or property, and that no adjacent buildings or walls encroach or project on said premises.

R. B. Bruce
R.B. Bruce, R.L.S., #1952

FILED
GREENVILLE CO. S.C.
Oct 18 3 30 PM '72
ELIZABETH RIDDLE
R.M.C.
W. H. WILLIMON

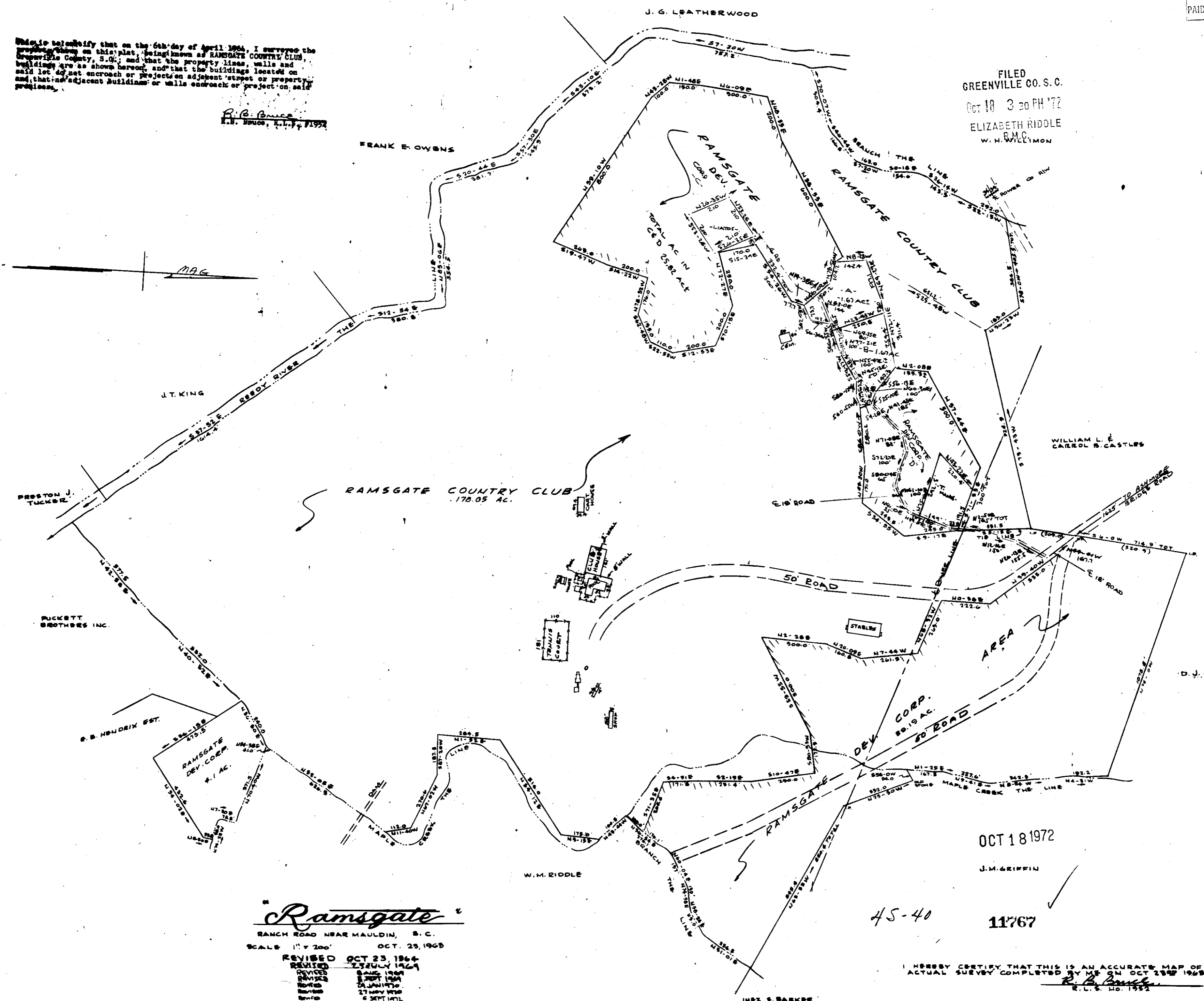

Ramsgate

RANCH ROAD NEAR MAULDIN, S.C.
SCALE 1" = 200' OCT. 23, 1963

REVISED OCT 23, 1964
REVISED 7 JULY 1964
REVISED 8 AUG 1964
REVISED 8 SEPT 1964
REVISED 27 JAN 1970
REVISED 6 SEPT 1972

CAROLINA ENGINEERING & SURVEYING CO.
GREENVILLE, S.C. 112 MANLY STREET

OCT 18 1972

J.M. GRIFFIN

45-40

11767

I HEREBY CERTIFY THAT THIS IS AN ACCURATE MAP OF AN ACTUAL SURVEY COMPLETED BY ME ON OCT 23RD 1963
R. B. Bruce
R.L.S. NO. 1952