

Name and Post Office Address of Grantor GEORGE LEE HOOPER
303 ECHO CIRCLE
FAISLEY SC 29640

Toll Line or Exchange Line tributary to GREENVILLE, SOUTH CAROLINA

The Property is bounded where the line enters and leaves this property by the property of:
YELLOWSTONE DR on the SOUTH
and UG CANTRELL, JR on the WEST
Authority C-6985 Classification R45C
Area GREENVILLE, SOUTH CAROLINA

Approved _____
Title _____

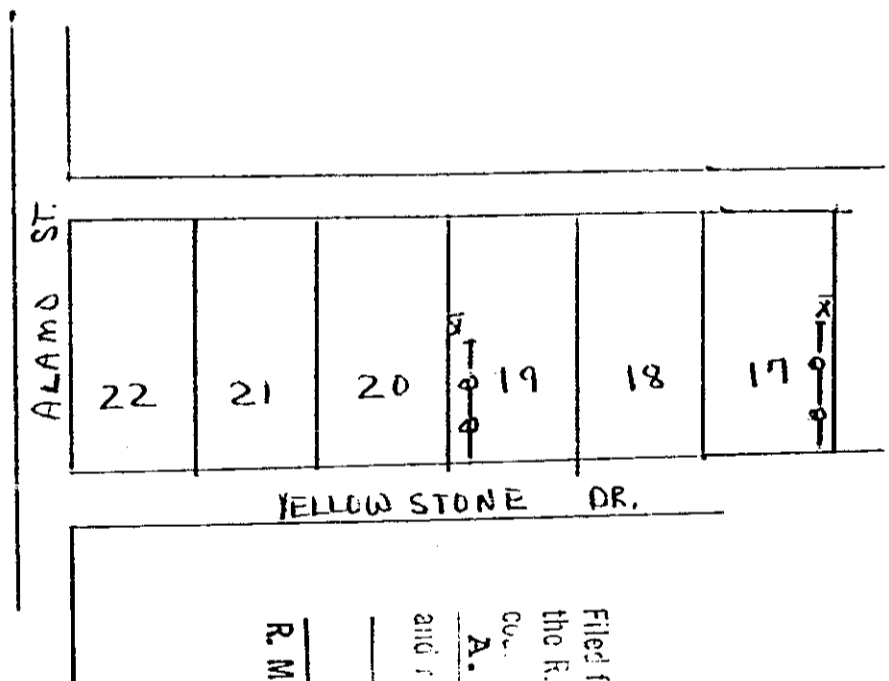

Filed for record in the office of
the R. M. C. for Greenville
at 11:12 o'clock
A.M. Oct. 27, 1980
and recorded in Deed Book
1136 at page 235
R. M. C. for G. Co. S. C.

RECORDED OCT 27 1980
at 11:12 A.M.

13082

OCT 27 1980
13082
Ax

13082

4328 RV.2