

Name and Post Office Address of Grantor GREENVILLE LODGE OF PERFECTION  
CLEVELAND ST.  
GREENVILLE, S.C. 29601

Toll Line or Exchange Line tributary to GREENVILLE EXCHANGE  
(Name) (Exchange)

The Property is bounded where the line enters and leaves this property by the property of:  
GNVL REFORM ASSOC. PRESBYTERIAN CHURCH on the NORTH  
and CLEVELAND ST. on the WEST

Authority HPO-5014-S Classification R-45C

Area SOUTH CAROLINA

Approved \_\_\_\_\_

Title \_\_\_\_\_

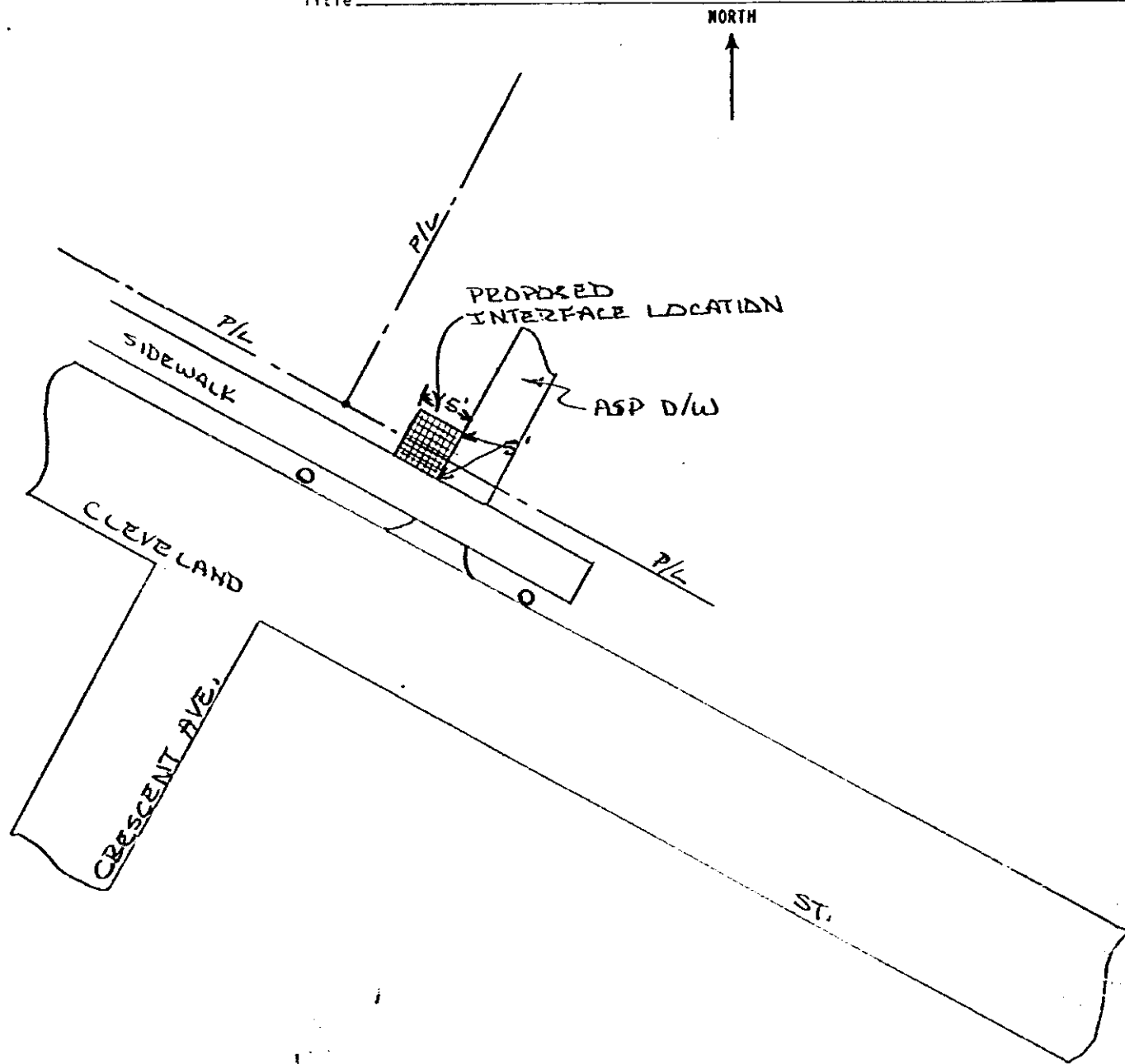

RECORDED OCT 27 1980

at 11:12 A.M.

13082

5  
2  
0

4328 RV-2