

W x H: B4 B



James D. Miller, A.S.C.E.  
Civil Engineer, No. 12345  
State of Alabama

Created by:  
Checked by:  
Date:

This site plan is prepared by James D. Miller, A.S.C.E., Civil Engineer, No. 12345, State of Alabama. It is based on the data furnished by the applicant and is subject to change without notice. The applicant is responsible for the accuracy of the data furnished.

VOL 1008 PAGE 127

1008  
127

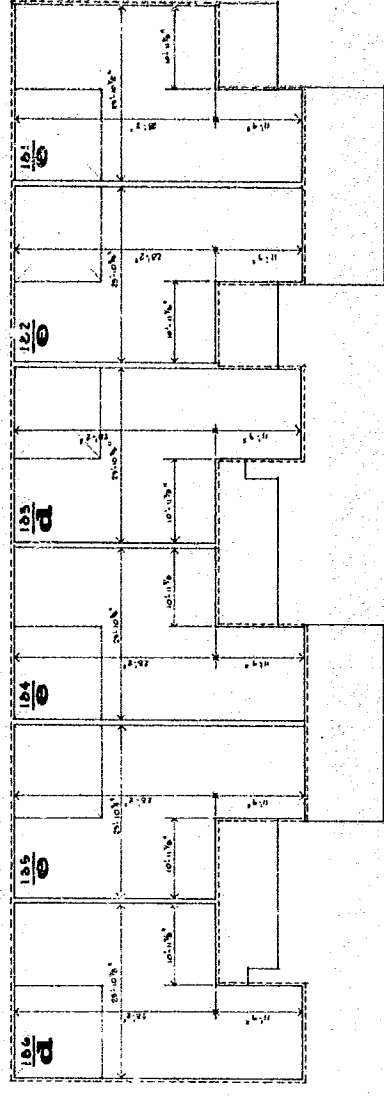

2nd fl.

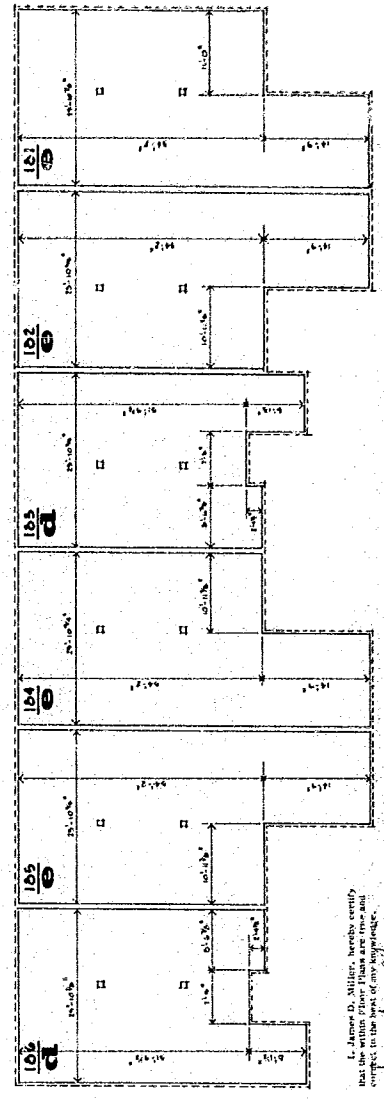

bldg. P 1st fl. INCLWOOD HORIZONTAL PROPERTY REGIME



James D. Miller, A.S.C.E.  
Civil Engineer, No. 12345  
State of Alabama

This site plan is prepared by James D. Miller, A.S.C.E., Civil Engineer, No. 12345, State of Alabama. It is based on the data furnished by the applicant and is subject to change without notice. The applicant is responsible for the accuracy of the data furnished.