

N

GREENVILLE COUNTY S.C.

VOL 974 PAGE 717

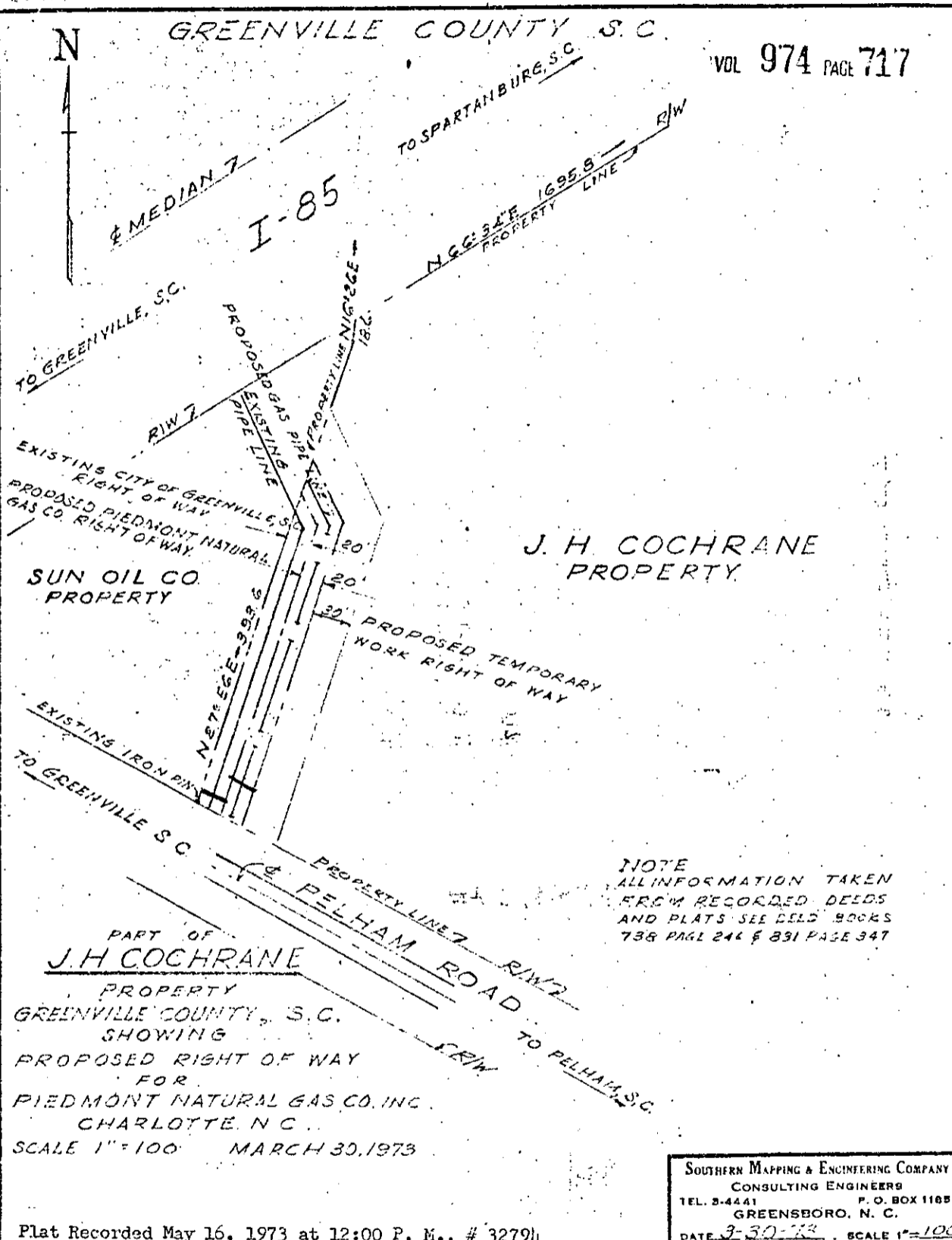

J. H. COCHRANE PROPERTY

NOTE ALL INFORMATION TAKEN FROM RECORDED DEEDS AND PLATS SEE DEED BOOKS 738 PAGE 246 & 831 PAGE 347

PART OF
J. H. COCHRANE
 PROPERTY
 GREENVILLE COUNTY, S.C.
 SHOWING
 PROPOSED RIGHT OF WAY
 FOR
 PIEDMONT NATURAL GAS CO. INC.
 CHARLOTTE, N.C.
 SCALE 1"=100' MARCH 30, 1973

SOUTHERN MAPPING & ENGINEERING COMPANY
 CONSULTING ENGINEERS
 TEL. 2-4441 P. O. BOX 1165
 GREENSBORO, N. C.
 DATE 3-30-73 SCALE 1"=100'

Plat Recorded May 16, 1973 at 12:00 P. M., # 32794