

MABEL W. COX LANFORD

TO GREENVILLE  
FOUNTAIN INN  
44 KV LINE

44 KV LINE

℄ IS ℄ OF BRANCH

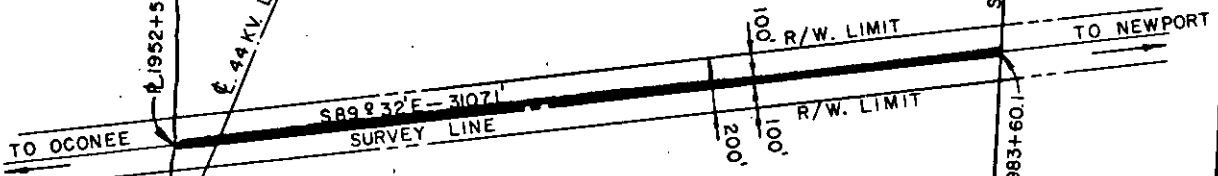

MAGGIE L. PUTNAM ET. AL.

FRANK NEVES

TO S.C. HWY. NO. 418

℄ IS ℄ OF JENKINS BRIDGE ROAD

TO CO. RD. NO. 55

Recorded February 28, 1969 At 1:35 P.M. # 20542

TO FORK SHOALS  
REF. DWG. NO. 100-36

DUKE POWER COMPANY  
 OCONEE-NEWPORT  
 TRANSMISSION LINE  
 CROSSING PROPERTY OF  
 MAGGIE L. PUTNAM ET. AL.  
 NEAR FORK SHOALS S. C.  
 OAKLAWN TOWNSHIP  
 GREENVILLE COUNTY

SCALE 1"=600'  
BOOK NO. 1081

FEBRUARY 4 1969  
FILE NO. 42-175

T.O. 7075-152