

CORRINE PAGE SPROUSE
REF: DWG NO. 22-90

HATTIE SINGLETON ESTATE

RUTH VIRGINIA FLETCHER

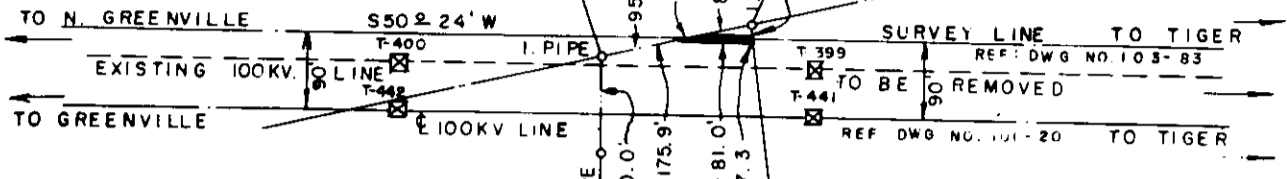

H. W. WILBURN

HASKEL MORGAN

W. S. WALKER

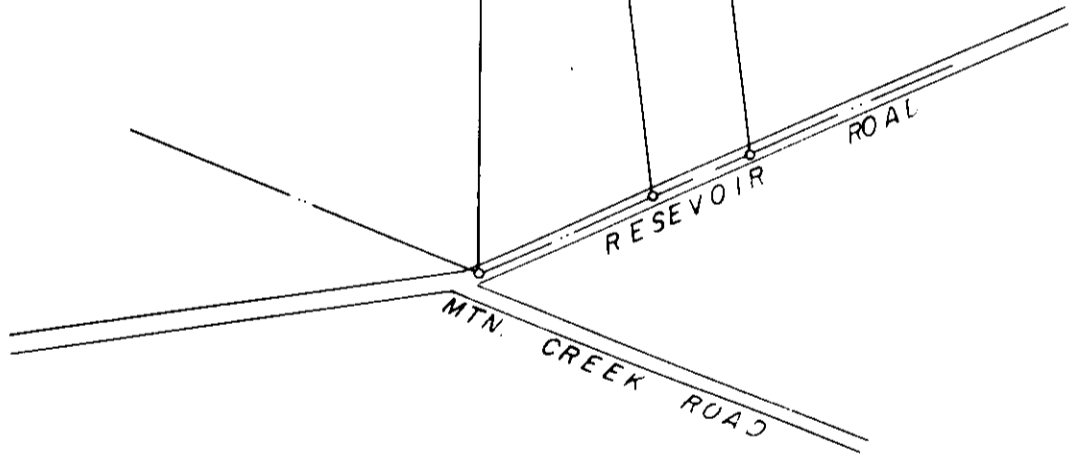

DUKE POWER COMPANY
TIGER - N. GREENVILLE
TRANSMISSION LINE
CROSSING PROPERTY OF
W. S. WALKER
CHICK SPRINGS TOWNSHIP
GREENVILLE COUNTY, S. C.

Recorded July 3rd, 1963 at 4:33 P.M. #847

SCALE: 1" = 200'
BOOK NO. 659

JUNE 7, 1963
FILE NO. 23-18