

MICROFILMED

RECORDING FEE  
PAID \$ 1.00

-73-

-74-

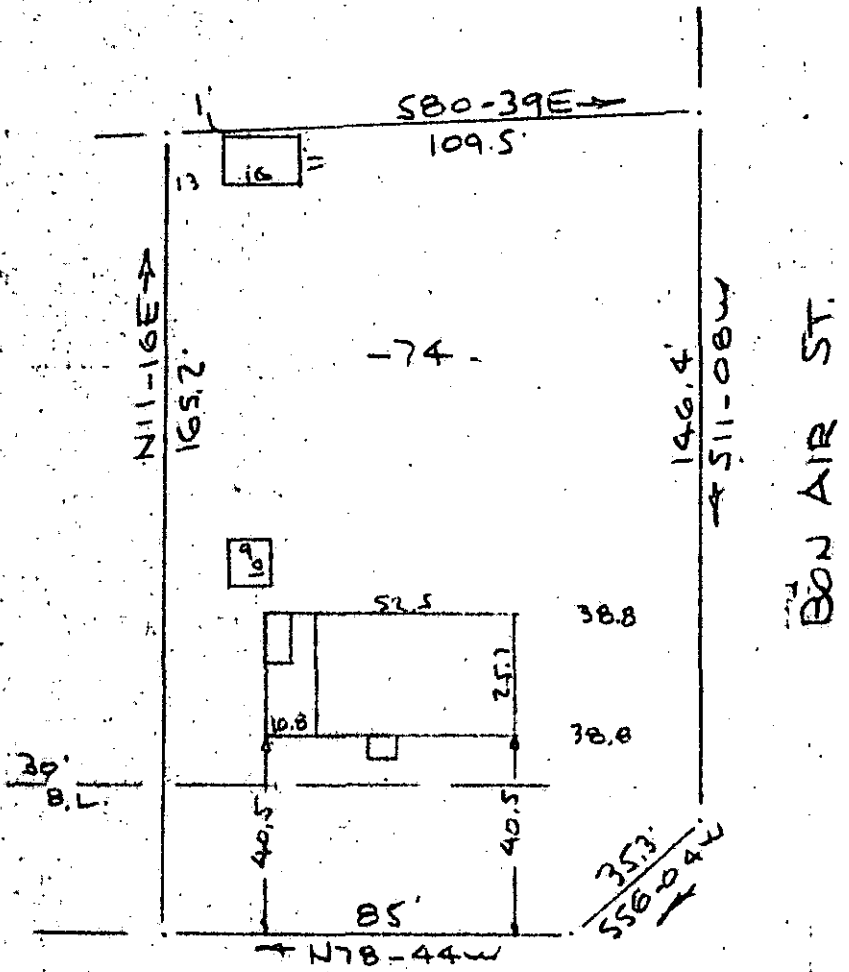

FAIRFIELD DRIVE  
WATER & SEWER IN ST. R/W

PROPERTY OF  
GEORGE EDWARD BAILEY & BARBARA B. BAILEY  
MAULDIN, GREENVILLE, CO. S. C.  
SCALE: 1" = 40' 29 MAR 1972

This is to certify that on the 29th day of March 1972, I surveyed the property shown on this plat, being known as lot 74 on plat of GLENDALE and recorded in the RMC Office Greenville County, S.C., in Plat Book "KK" at Pages 128 & 129; and that the property lines, walls and buildings are as shown hereon, and that the walls and buildings located on said lot do not encroach or project on adjacent street or property, and that no adjacent walls or buildings encroach or project on said premises, and no power lines cross this property except as shown hereon.

*R. B. Bruce*  
R. B. Bruce, RLS #1952

27206

40-15 ✓

APR 10 1972

CAROLINA SURVEYING COMPANY  
112 Manly Street  
Greenville, S. C.

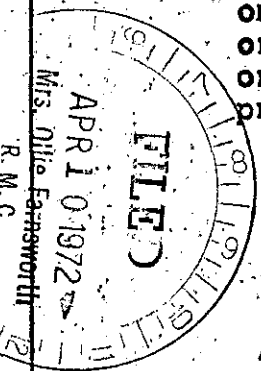

112112