

TOWN PARK OF GREENVILLE

HORIZONTAL PROPERTY RESUME
GREENVILLE COUNTY, SOUTH CAROLINA

BUILDINGS : A, B, C, D, E, F, G, H, O, P, Q, 4R

EAST NORTH STREET EXTENSION
(OLD SPARTANBURG ROAD)

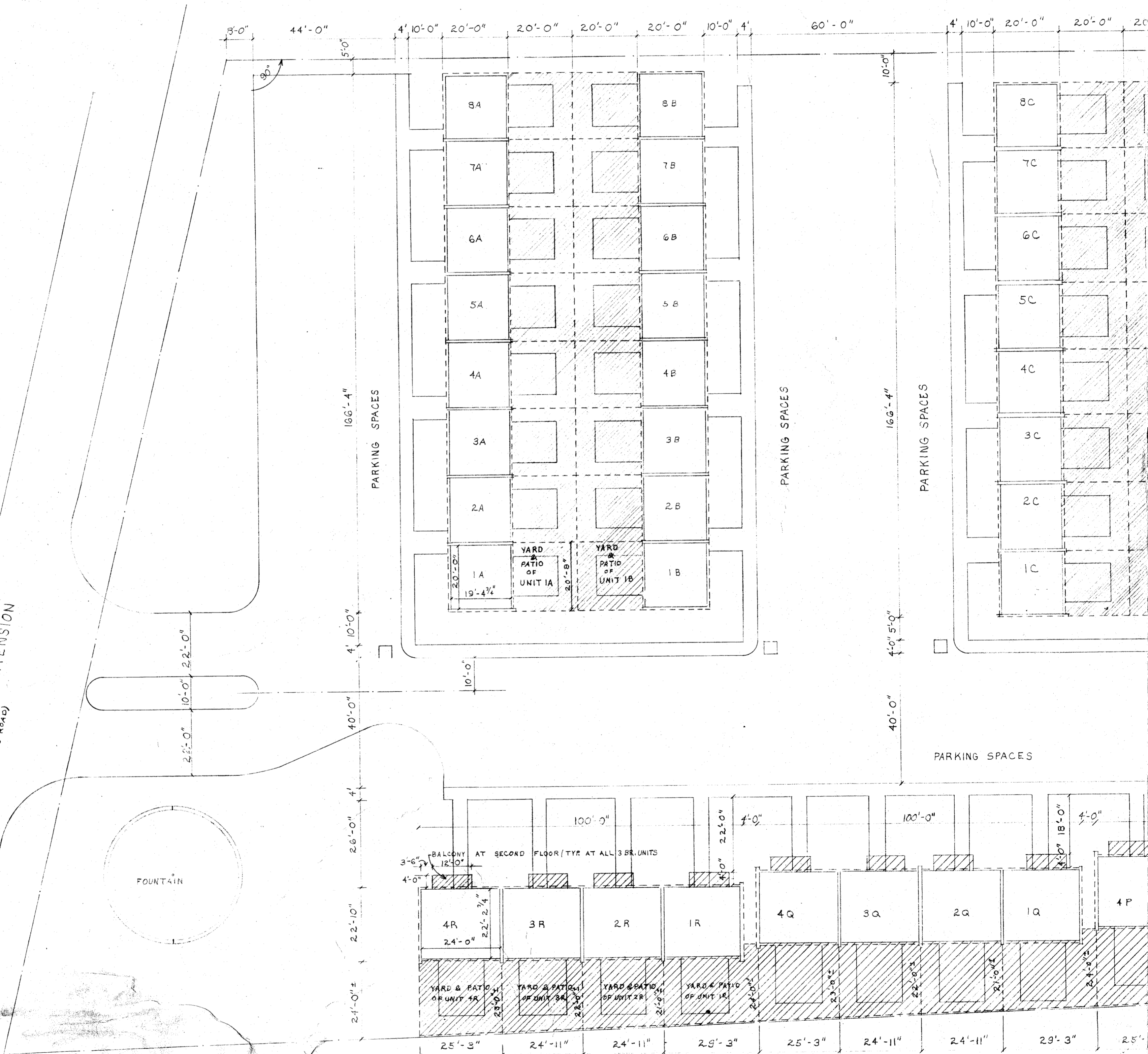

- NOTE
- 1- BUILDINGS A, B, C, D, E SHOWN IN THIS PLAN ARE TWO STORY STRUCTURES WITH 2 BEDROOMS UNITS. DIMENSIONS SHOWN IN UNIT 1A ARE TYPICAL FOR EACH OF THE 3 UNITS OF EACH BUILDING.
 - 2- BUILDINGS F, G, H, O, P, Q, 4R SHOWN IN THIS PLAN ARE TWO STORY STRUCTURES WITH 3 BEDROOMS UNITS. DIMENSIONS SHOWN IN INSIDE OF UNIT 4R ARE TYPICAL FOR EACH OF THE 4 UNITS OF EACH BUILDING. YARD DIMENSIONS AS SHOWN IN EACH CASE.
 - 3- EACH UNIT CONSISTS OF THE SPACE BOUNDED BY THE UNDECORATED AND/OR UNFINISHED SURFACES OF THE PERIMETER WALLS, FLOORS, AND CEILINGS.
 - 4- ALL INTERIOR ANGLES OF UNITS ARE 90°.
 - 5- PARKING SPACES ARE LIMITED COMMON ELEMENTS NOT WITHSTANDING, LEGEND AND SAID SPACES ARE FOR THE USE OF UNIT OWNERS, SPECIFIC PARKING SPACES TO BE ASSIGNED BY THE ASSOCIATION.

EXHIBIT "A"
SHEET NO. 2 OF 3