

Plat Book 46, Page 73

TOWN PARK OF GREENVILLE, C. C.

HORIZONTAL: PROPERTY RAIME
GREENVILLE COUNTY SOUTH CAROLINA

BUILDINGS I, J, K, L, M & N

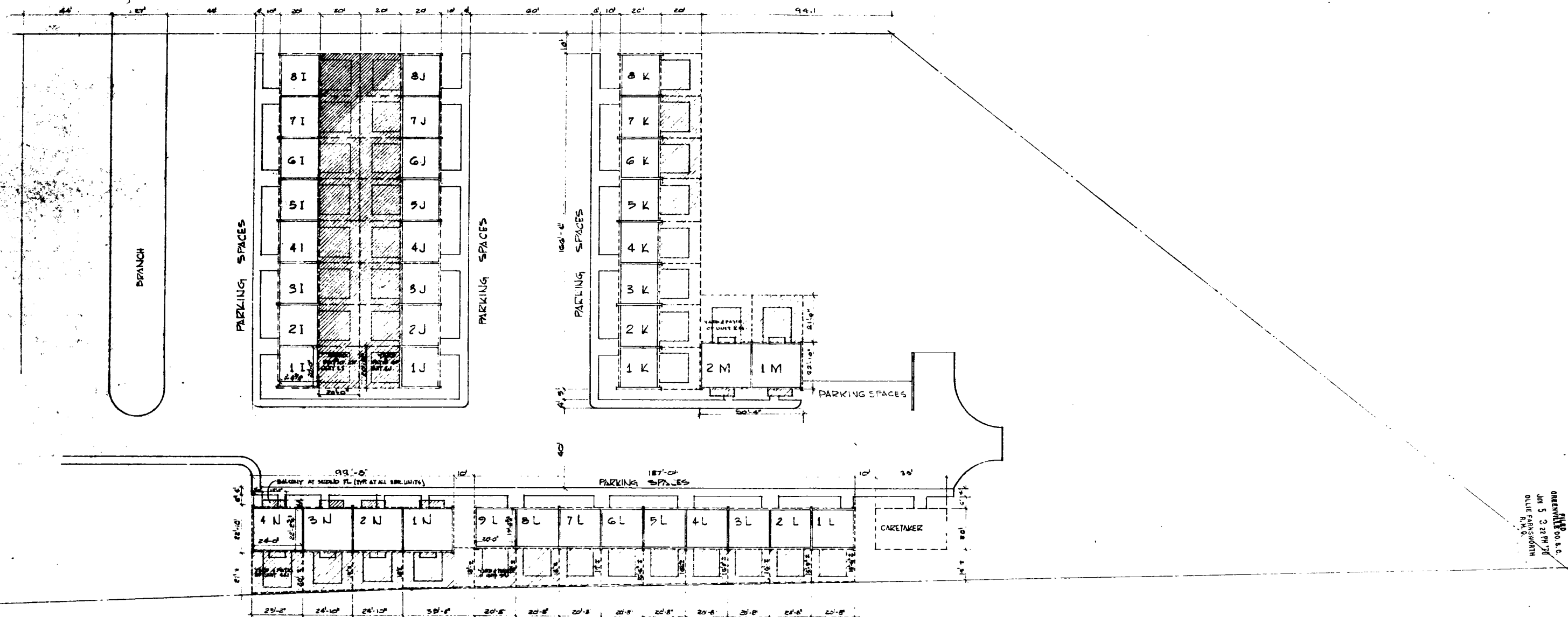

NOTES

- 1- BUILDINGS I, J, K, L SHOWN IN THIS PLAN ARE TWO STORY STRUCTURES WITH 2 BEDROOMS UNITS. DIMENSIONS SHOWN IN UNIT 1I ARE TYPICAL OF EACH 2 BEDROOM UNIT.
- 2- BUILDINGS M & N SHOWN IN THIS PLAN ARE TWO STORY STRUCTURES WITH 3 BEDROOM UNITS. DIMENSIONS SHOWN IN UNIT 4N ARE TYPICAL OF EACH 3 BEDROOM UNIT. YARD DIMENSIONS ARE SHOWN IN EACH CASE.
- 3- EACH UNIT CONSISTS OF THE SPACE BOUNDED BY THE UNDECORATED AND/OR UNFINISHED SURFACES OF THE PERIMETER WALLS, FLOORS & CEILING.
- 4- ALL INTERIOR ANGLES OF UNITS ARE 90°
- 5- PARKING SPACES LIMITED COMMON ELEMENTS NOT WITHSTANDING LEGEND AND SAID SPACES ARE FOR THE USE OF UNIT OWNERS; SPECIFIC PARKING SPACES TO BE ASSIGNED BY THE ASSOCIATION

LEGEND

- INDICATES BOUNDARY OF UNIT
- - - - - INDICATES COMMON ELEMENTS
- INDICATES UNITS COMMON ELEMENTS

6.00 46-73

THIS PLAT IS NOT A SUBDIVISION
AS DEFINED BY THE GREENVILLE
COUNTY SUBDIVISION REGULATIONS.
6.5.1970
William H. Homan
Planning, Secretary or Director of
Greenville County Planning Council, Inc.

JUN 5 1970
287589

EXHIBIT 'A'
SHEET NO. 3 of 3

GREENVILLE CO. S.C.
JUN 5 3 22 PM '70
OLIVE FARM SOUTH
N.Y.