

# 17777 Filed This 28 day of Jan. 19 69

And Recorded in Vol. 4 A Page 25 at 10:48 AM

Ollie Farnsworth

Register Mesne Conveyance Greenville County, S. C.

JAN 28 10 48 AM 1969

OLLIE FARNSWORTH

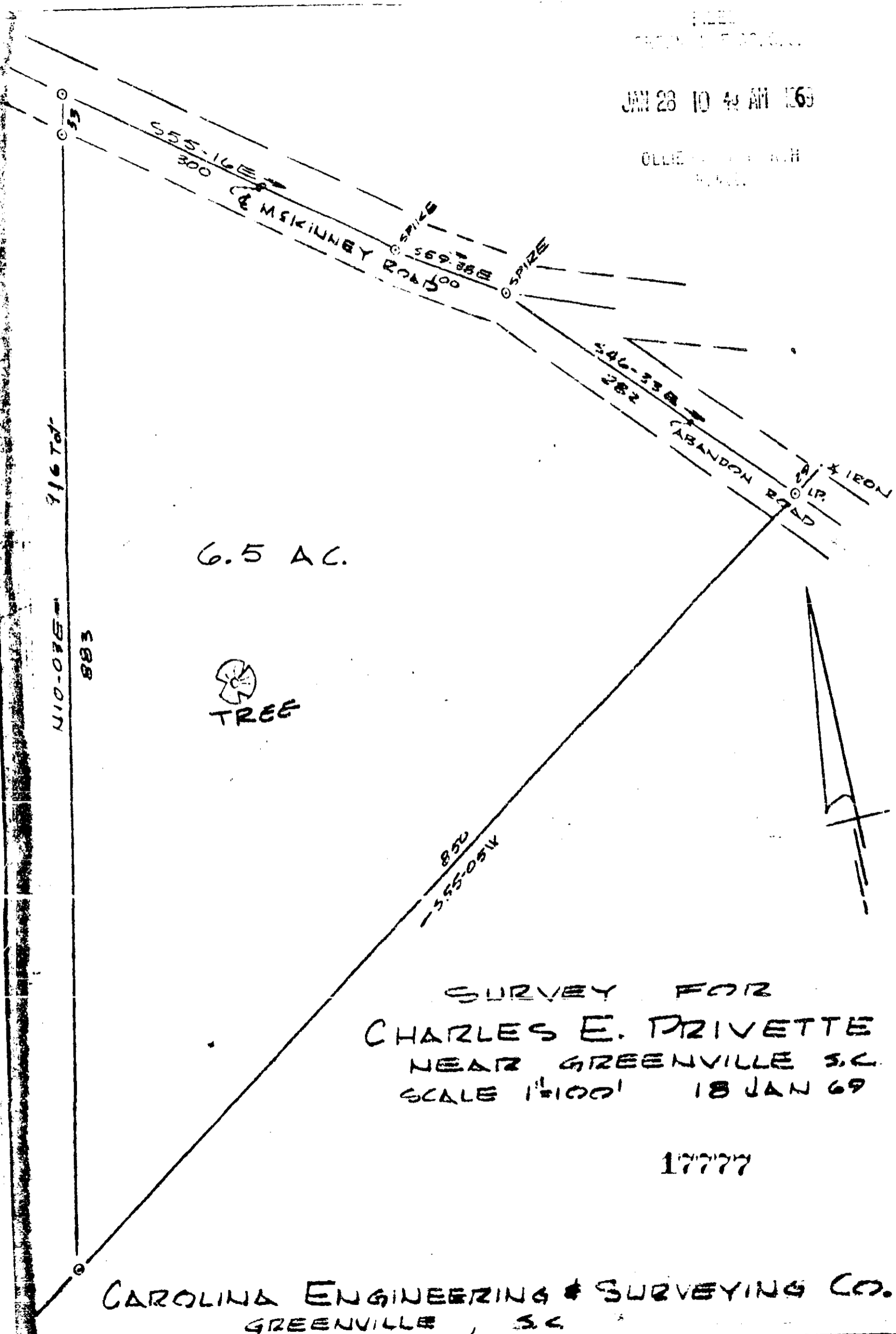

SURVEY FOR CHARLES E. PRIVETTE NEAR GREENVILLE S.C. SCALE 1"=100' 18 JAN 69

17777

CAROLINA ENGINEERING & SURVEYING CO. GREENVILLE, SC

45/51 4A - 25 See 507

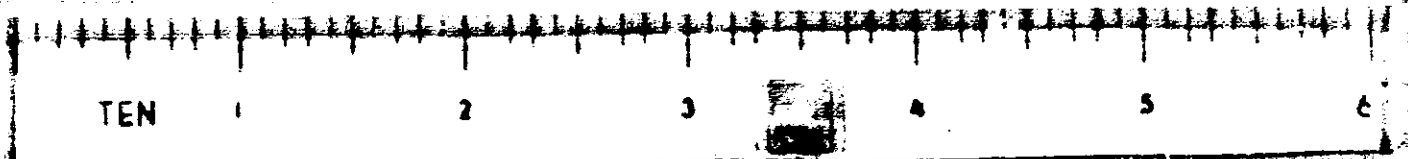

25