

0469

Name and Post Office Address of Grantor: Sloan Construction Co., Inc.
1600 W. Washington, St.
Greenville, S. C.

Toll Line or Exchange Line tributary to: Greenville, S. C.

The Property is bounded where the line enters and leaves this property by the property of:
Bramlette Rd. on the South
West Washington Rd. on the West

Authority: P-43369 Classification: R45C
 Area: Greenville, S. C.

Approved: [Signature]
 Title: Dist. Mgr. Dist.

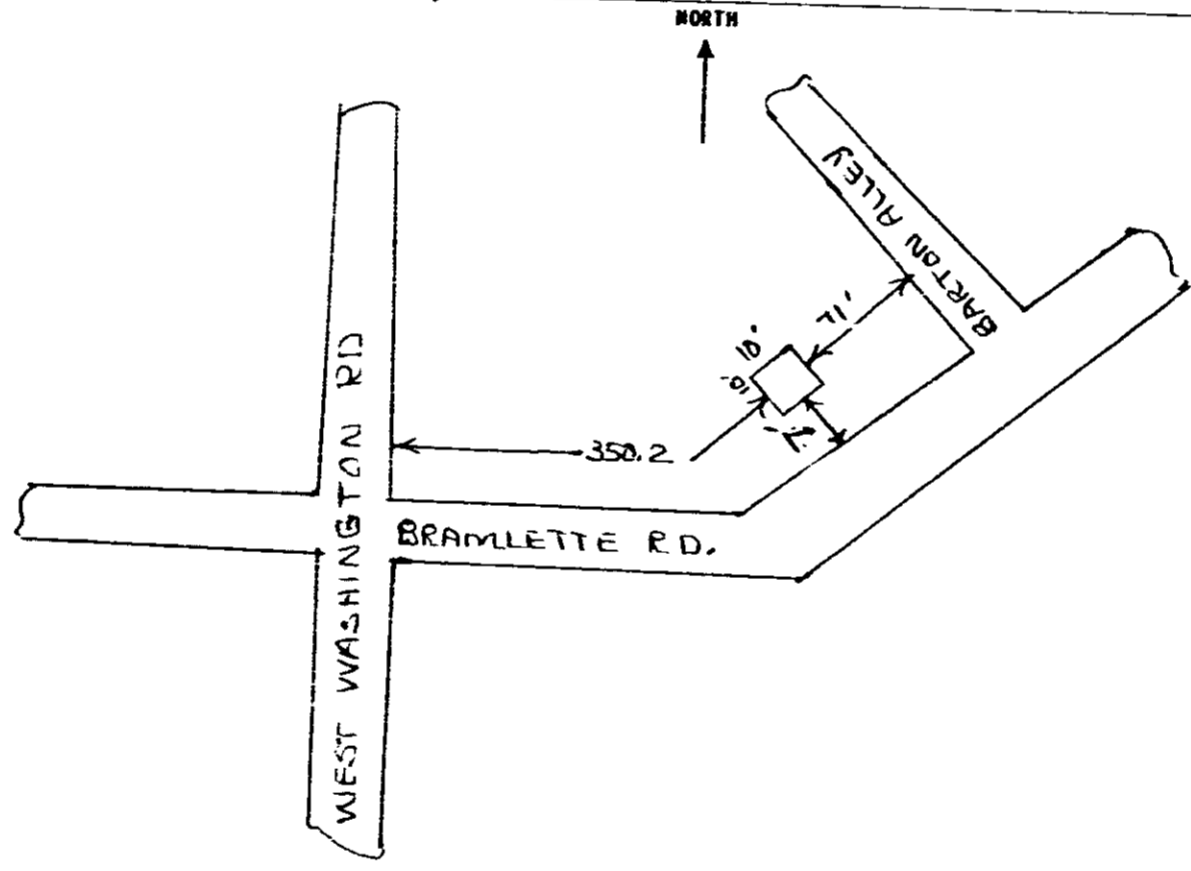

[Handwritten signature]

RECORDED JUL 10 1970

915

4328 RV-2