

578

00776

Vol. 955 pg. 840

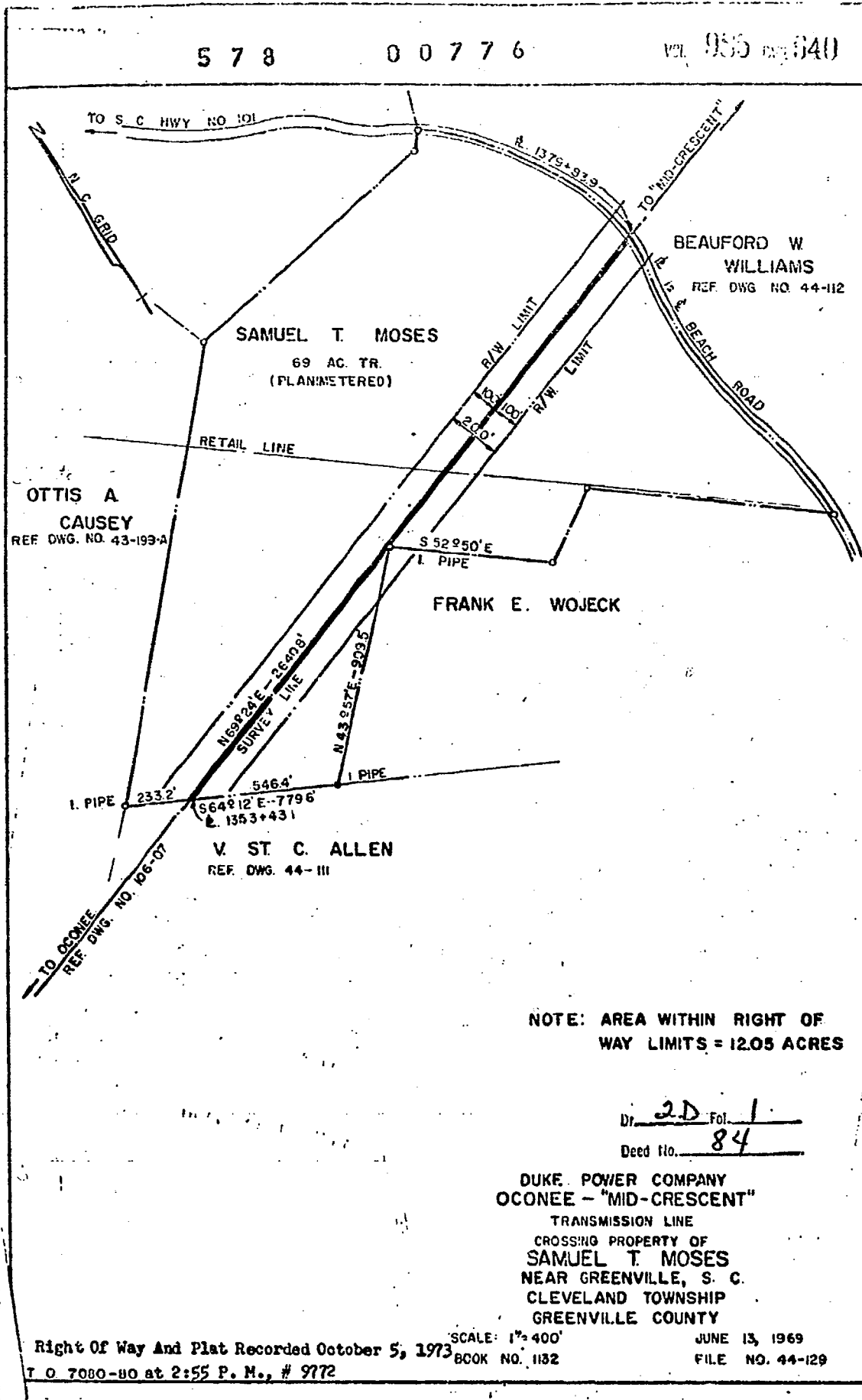

NOTE: AREA WITHIN RIGHT OF WAY LIMITS = 12.05 ACRES

Dt. 2D Fol. 1
Deed No. 84

DUKE POWER COMPANY
OCONEE - "MID-CRESCENT"
TRANSMISSION LINE
CROSSING PROPERTY OF
SAMUEL T. MOSES
NEAR GREENVILLE, S. C.
CLEVELAND TOWNSHIP
GREENVILLE COUNTY

Right Of Way And Plat Recorded October 5, 1973
T O 7080-80 at 2:55 P. M., # 9772

SCALE: 1" = 400'
BOOK NO. 1132

JUNE 13, 1969
FILE NO. 44-129

4328 IV-2