

CONE MILLS CORPORATION
"FLORENCE DIVISION - AMERICAN SPINNING PLANT"

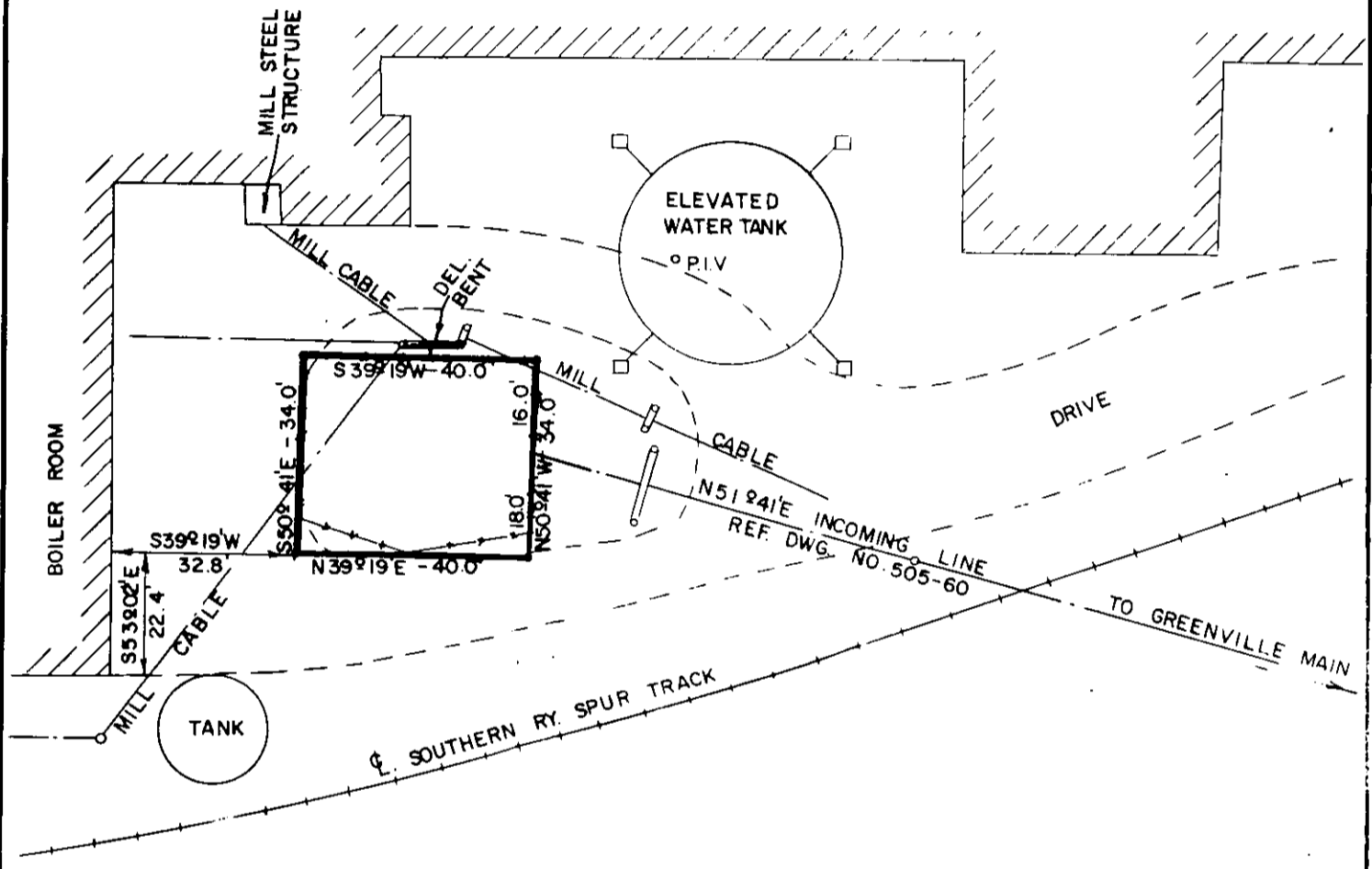

NOTE: REF. DWG. NO. 2-59.

For Substation Lease to this property, see Page 121 in this book.

DUKE POWER COMPANY
SUBSTATION LOT
LEASED FROM
CONE MILLS CORPORATION
"FLORENCE DIVISION - AMERICAN SPINNING PLANT"
GREENVILLE, S. C.
GREENVILLE COUNTY

SCALE: 1" = 30'
BOOK NO. 684

APRIL 18, 1963
FILE NO. 22-96

Recorded May 17th., 1963 at 9:30 A.M. No. 29606