



**Greenville
County**

COMMUNITY PROJECT ACCOUNT
(Small, De Minimus Public Projects)

APPLICATION

1) Name of Project: Paracyclist access on Swamp Rabbit Trail and Berea Community Gateway signage

Check Project Type:

X Nonrecurring community requests for infrastructure:

- Flooding
- Roads
- Lights
- Sewer and drainage
- X Public buildings and grounds**
- Infrastructure related studies

Contributions to local governments in Greenville County for community projects

2) Amount of Funds Requested: \$ 18,000

3) Project Sponsor

Organization: Greenville County Recreation District in partnership with Leadership Greenville Class of 39 and the Berea Community Master Plan Committee

Mailing Address: 4806 Old Spartanburg Rd
Taylors, SC 29687

4) Contact Person:

Name Ty Houck Title Dir. of Greenways
Telephone 864-676-2180 x 141 Alt. Telephone No. 864-331-9631
Email ty@gcrd.org Fax No. 864-288-6499
Council Representative(s) Willis Meadows

5) Project Timeline ~ Beginning: June 15, 2013 Ending: August 15, 2013
MONTH/DAY/YEAR MONTH/DAY/YEAR

6) Date Funds are Needed: As soon as available

7) Location of Project: Swamp Rabbit Trail at Sulphur Springs Rd and Pinsley Circle

8) Project Description: (Attach additional pages if necessary)

a. General Description: Development of a "Pocket Park" centered around the old railcar and eye-catching signage identifying the Berea Community. (See attached images) \$35,000 has already been raised through donations. The additional \$18k funding requested will allow for additional aspects of the park to be built in phase one, aspects that include handicap access into the restored railcar to view history exhibits about the railroad and development of the Swamp Rabbit Trail, creation and installation of "gateway" signage over Sulphur Springs Rd that will create community pride and recognition for Berea.

b. Benefit project will provide the Community: The numbers tell the benefit that this project will have – 359,000 users annually on the Swamp Rabbit Trail, businesses along the trail reporting between 30-85% of revenue coming from trail users. The focus group for the Swamp Rabbit Impact study identified the SRT as "one of Greenville's primary assets" With construction of this project, the above facts will have more of an impact on the Berea community because right now those 359,000 users don't have a reason to stop in Berea. Studies show that parks are catalysts to community vibrancy and reinvestment. By creating a reason to stop and linger at an inviting park in the Berea community, public investment will spark private investment just like it has in Travelers Rest and at Cedar Lane Rd. Community pride will also be reinvigorated as residents see vacant buildings occupied where employees and employers can use the SRT to get to work, this already the case a Kel Chemical right next to this location.

c. Additional Comments: Since the SRT is meant to be a trail for everyone it is important that we have input from everyone. With that in mind and we are working with paracyclists to specifically design this space to meet their unique needs because nowhere else in the Upstate are their basic needs met. Through this approach the SRT and

specifically this location will become known as a meeting spot that kept the special needs of these trail users in mind. Something that will remind everyone that Greenville works hard to be inclusive and not just accommodating. Videos related to this project are available at:

<http://www.youtube.com/watch?v=892U9hdobpQ> and

<http://www.youtube.com/watch?v=mE7WjraKh0w>

9) Project Budget:

- a. Total Project Budget including all sources of funds: \$ \$65,400
- b. Percent request equals of the total Project Budget? 27%

List below all funding sources for this project:

Funding Source	Amount
Leadership Greenville Engraved Brick sales	\$16,000
Greenville County Recreation District	\$6,200
Greenville County	\$6,200
Leadership Greenville donations	\$4000
Greenville Civitans grant	\$5000
Spinx donation	\$10,000
Community Project Account	\$18,000
In-kind donation – Greenville Spinners (bike repair station)	
In-kind donation – Greenville Track Club (water fountain)	
In-kind donation – Greenville Water System (water fountain)	
TOTAL:	\$65,400



Signed

5/23/2013
Date

Director of Greenways, Natural and Historic Resources
Title

Branding Berea

Phur Springs Gateway

Impactful Gateway:

- Crossing
- tting
- mation Kiosk
- r Veiwing Area

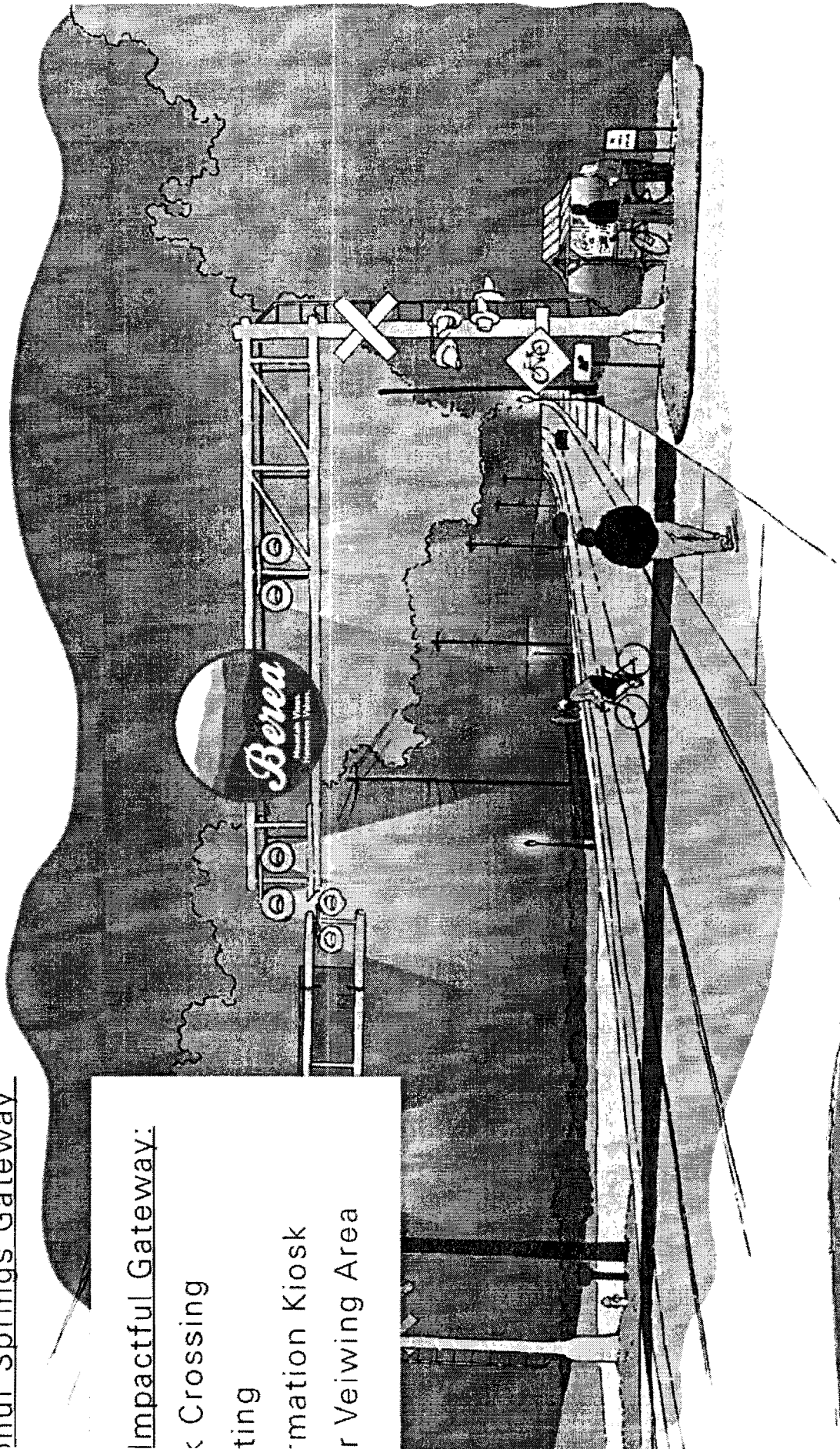

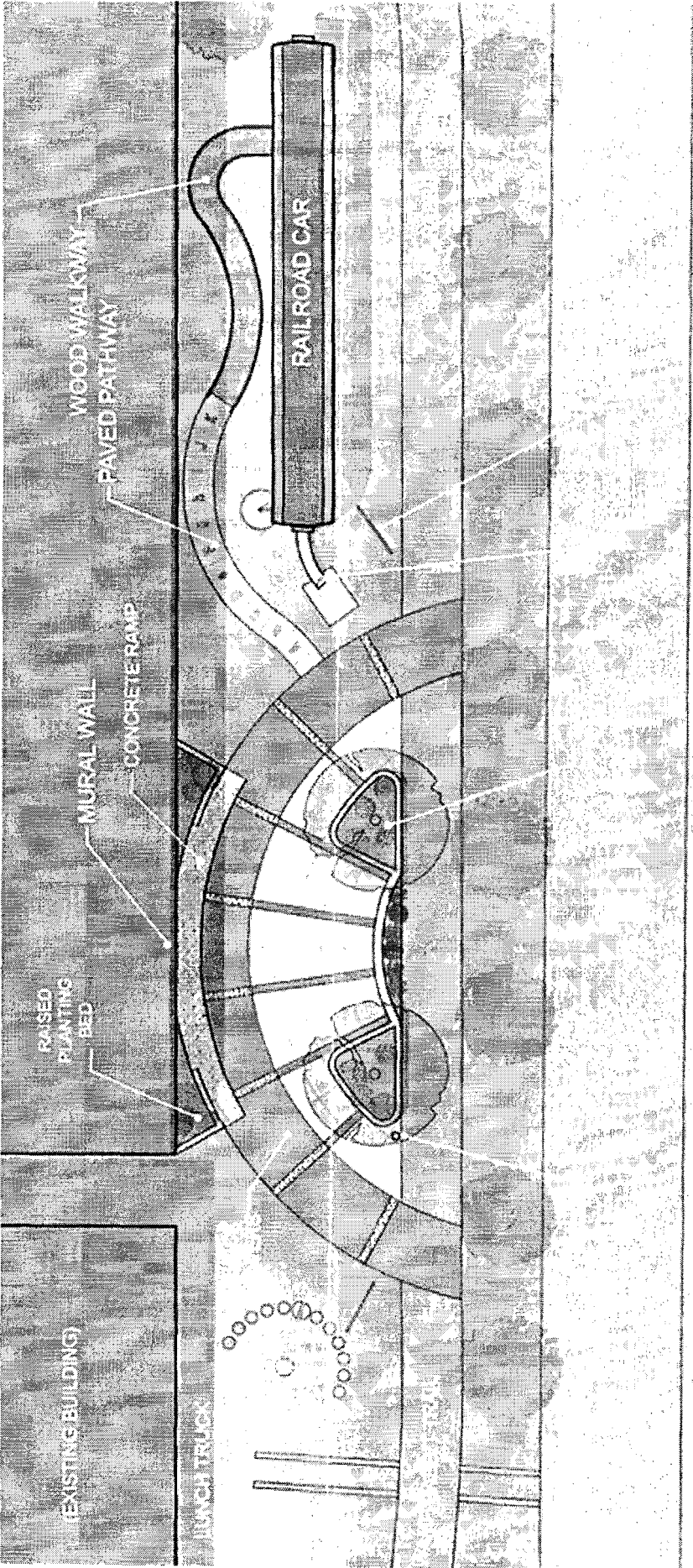

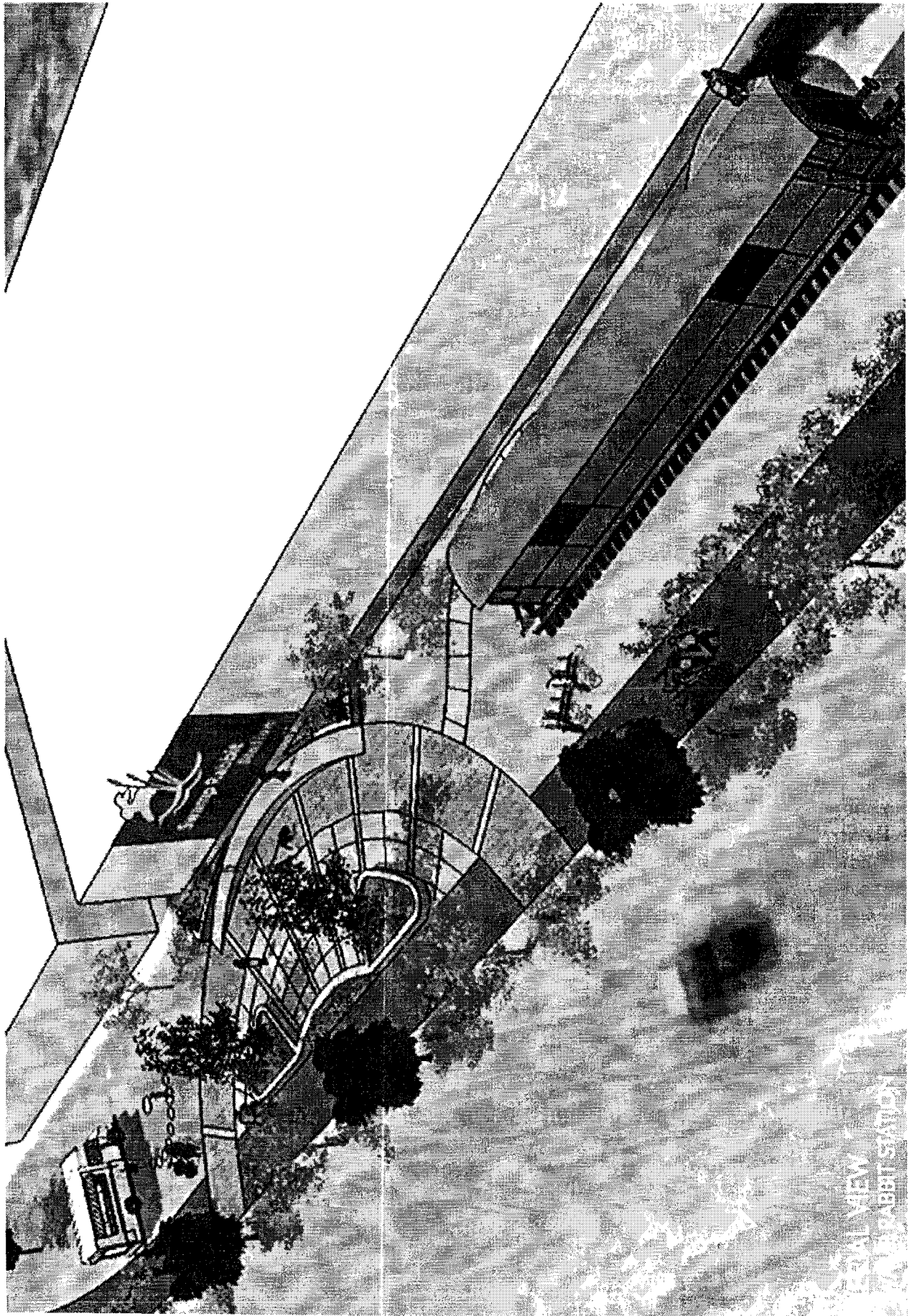

KERALA VIEW
WITH RABBIT STATION